

The Commons Act 2006 – Section 19
Notice of an Application for the correction of the Commons Register

To every reputed owner, lessee, tenant or occupier of any part of the land described below, and to all others whom it may concern.

An application has been made to the Commons Registration Authority, Norfolk County Council, by Mr Steven Wade under section 19(2)(a) of the Commons Act 2006 and in accordance with the Commons Registration (England) Regulations 2014. The applicant seeks the correction of the commons map and registers of CL 50, Thwaite Common, in the Parish of Alby-with-Thwaite, Norfolk, by the removal of land (Area 'A') at Goose Lane Farmhouse, Thwaite Common, Erpingham, NR11 7QG as edged and shaded red on the plan accompanying the application. The basis of the application is that the land known as 'Area A' was excluded from the original application for registration of Thwaite Common dated 21 August 1967 but was mistakenly included by the Commons Registration Authority in the provisional registration of 17 October 1967, which being undisputed, became final on 1 August 1972.

If the application is granted the Commons Registration Authority will give effect to the determination by removing the land from the register of common land.

Representations:

- must quote the Application No. CL50/1/48015
- must state the name and postal address of the person making them, and the nature of that person's interest (if any) in any land affected by the application, and may include an e-mail address
- must be signed by the person making them;
- must state the grounds on which they are made; and
- must be sent to: The Legal Orders and Registers Team, Community and Environmental Services, Norfolk County Council, County Hall, Martineau Lane, Norwich NR1 2SG or by email to denise.bales@norfolk.gov.uk

Any representations made will not be treated as confidential but will be dealt with in accordance with regulation 25. If the application is referred to the Planning Inspectorate for determination in accordance with regulation 26, any representations will be sent with it for consideration. The date on which the period for making representations expires is 26 October 2015.

Documents relating to the application are available for inspection at Norfolk County Council, Carrow House, 301 King Street, Norwich, NR1 2TN from 11 September 2015 up to and including 26 October 2015 between the hours of 9am to 4.30pm Monday to Friday however an appointment is required. Please telephone (01603) 223009.

This Notice and accompanying plan can also be viewed by accessing the Councils website www.norfolk.gov.uk/commonland

Dated: 11 September 2015

Signed

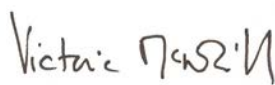

Victoria McNeill, Head of Law and Monitoring Officer
Norfolk County Council

Goose Lane Farm

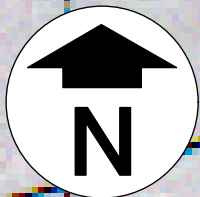

Well

Other land in same ownership shaded blue

AREA A shaded red

Well



Scale

PLAN REFERRED TO IN THE APPLICATION FOR CORRECTION OF THE REGISTER UNDER SECTION 19 OF THE COMMONS ACT 2006

Scale 1:500 Date August 2015 Drawing TC / 01

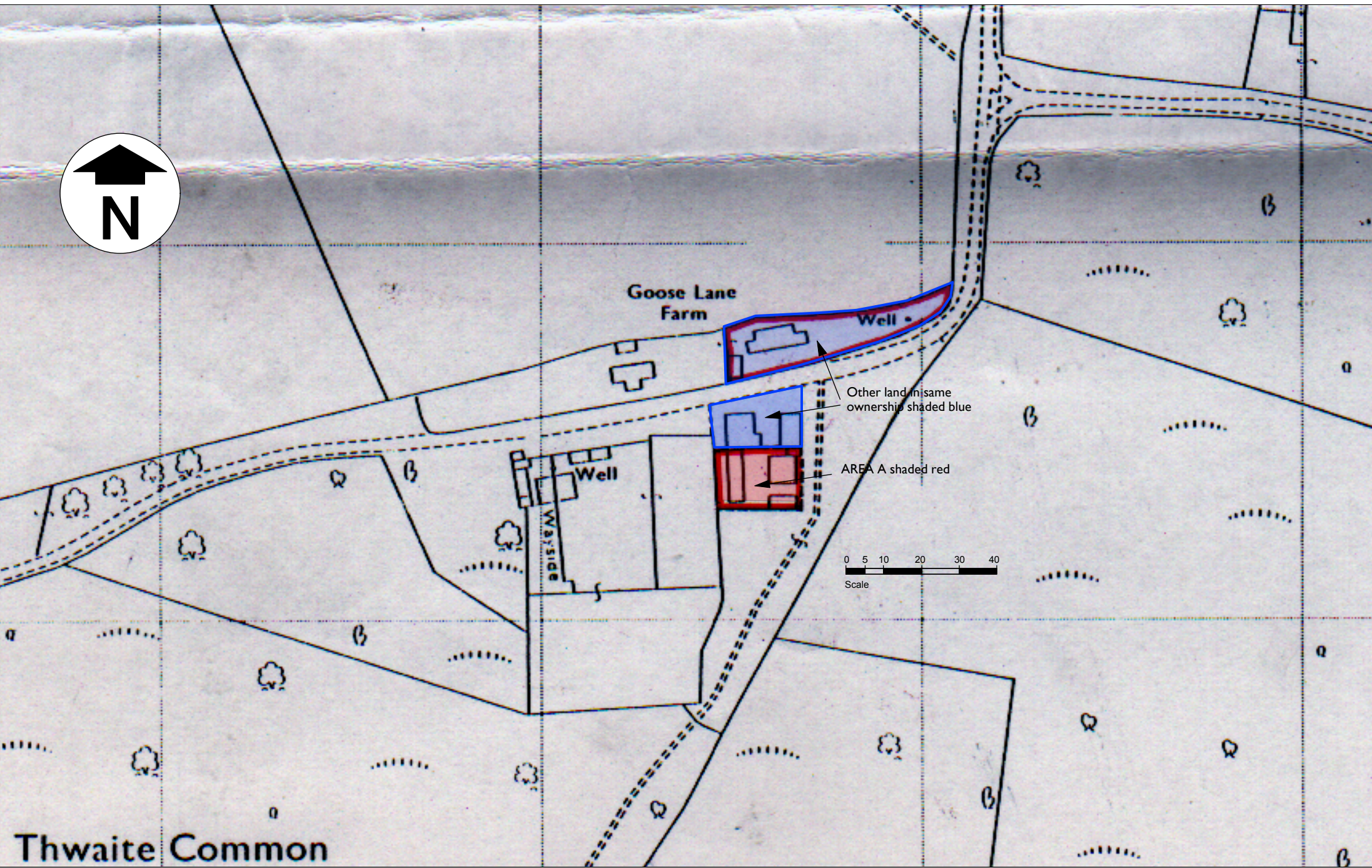
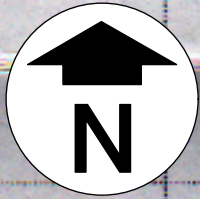

LOCATION PLAN TO IN THE APPLICATION FOR CORRECTION OF THE REGISTER
UNDER SECTION 19 OF THE COMMONS ACT 2006

Scale 1:1250 Date August 2015 Drawing TC / 02