

Ian Sharman, Esq.
Community and Environmental Services
Norfolk County Council, County Hall
Martineau Lane, Norwich
NR1 2SG

I, Dr David Ormerod of Mill House, 7 Mill Lane, Swaffham, Norfolk PE37 7EU hereby apply for an order under section 53(2) of the Wildlife and Countryside Act 1981 to modify the definitive map and statement for the area by:

The Application Route extends from TF 70171242 arising from the junction of Common Lane and River Road and runs for approximately 200 yards in a southerly direction to the front of Pentney Priory Gatehouse at TF 70091218 - in Pentney Parish. At present, the Application Route has no public right of access according to the Definitive Map. There is a sign on an open gate at the beginning of this road announcing that this is a private road, and signage within the Gateway compound denies public access to the Application Road and to the front of the Gatehouse.

I attach copies of the following documentary evidence :

- Ordnance Survey 25-inch County Series, Sheet 46.13, 1905
- Finance Act (1909-10) I.R.S. Duties on Land Values Map, Pentney
- Photograph from Point A at northern end of Application Route at Point A, looking south
- Photograph of front of Pentney Priory Gatehouse, at Point B.
- Photograph taken from behind the southwestern corner of Pentney Priory Gatehouse, at the end of Pentney FP3, showing the signage preventing access to the Application Route.
- Bowen's Accurate Map of Norfolk, 1749
- 'Norfolk Mills' website description of the adjacent Pentney Watermill
- Faden's Map of Norfolk, 1797
- Pentney Enclosure Award and Map, 1807/9
- Thomas Yeakall's Lynn Regis Map, 1813
- Ordnance Survey First series 1-inch map, Pentney, 1824
- Bryant's Map of Norfolk, 1826
- Tithe Map for Pentney Parish 1851
- Drainage Map for Pentney and West Bilney, 1879
- Ordnance Survey 25-inch Norfolk Map, Sheet 46.13, 1888

- Ordnance Survey Revised New Series 1-inch map, Sheet 140, Kings Lynn Hills, 1897
- Bartholomew Half-inch map of England and Wales, Norfolk Sheet 15, 1903
- Ordnance Survey Object Name Books, Norfolk Sheet 46SW, 1904
- Ordnance Survey 25-inch Norfolk Sheet 46.13, 1905
- Finance Act (1909-10) I.R.S. Duties on Land Valuation Map, Pentney
- Bartholomew Half-inch map of England and Wales, Norfolk Sheet 15, 1921
- Ministry of Food National Farm Survey Map, Sheet 46, 1943
- Bartholomew Half-inch map of England, Wales, and Scotland, Norfolk Sheet 26, 1943
- Photograph of visitors and cars at Pentney Priory Gatehouse, 1958
- Ashwood Lodge Farm Sale Map, 1951
- Ordnance Survey 1:25,000 County Series Map, Sheet TF71, 1955
- Geo-referenced INSPIRE land index polygon map, 2018
- Historic England Map of Pentney Priory - from its dedicated Pentney Priory website, 2019
- DEFRA Magic Map of Pentney Priory area, 2019
- Applicant's statement.

Sincerely Yours,



L David Ormerod MB,BS, MBA, MSc, FRCP, FRCS, DTM&H

Applicant's Reference: EH 012

Wildlife and Countryside Act 1981

The Definitive Map and Statement of Public Rights of Way for the County of Norfolk

Certificate of Service of Notice of Application for Modification Order for the unnamed Road that runs from the southern termination of Common Lane, Pentney, up to the front of Pentney Priory Gatehouse.

Ian Sharman Esq.
Community and Environmental Services
County Hall, Norfolk County Council
Martineau Lane, Norwich
NR1 2SG

I, Dr David Ormerod of Mill House, 7 Mill Lane, Swaffham PE37 7EU hereby certify that the requirements of paragraph 2 of Schedule 14 to the Wildlife and Countryside Act 1981 have been complied with.

Dated: 30 April 2019

Signature:



Applicant's Reference: EN 012

NCC Reference:

Schedule of persons on whom notice was served

The owners and occupiers of the land crossed by the Application Route extends from TF 70171242 arising from the junction of Common Lane and River Road and runs for approximately 200 yards in a southerly direction to the front of Pentney Priory Gatehouse at TF 70091218 - in Pentney Parish.

Mr. Charlie Campbell, Managing Director, S.H.E. Group, Sedgeford Hall, Fring Road,
Sedgeford, Norfolk PE36 5LT

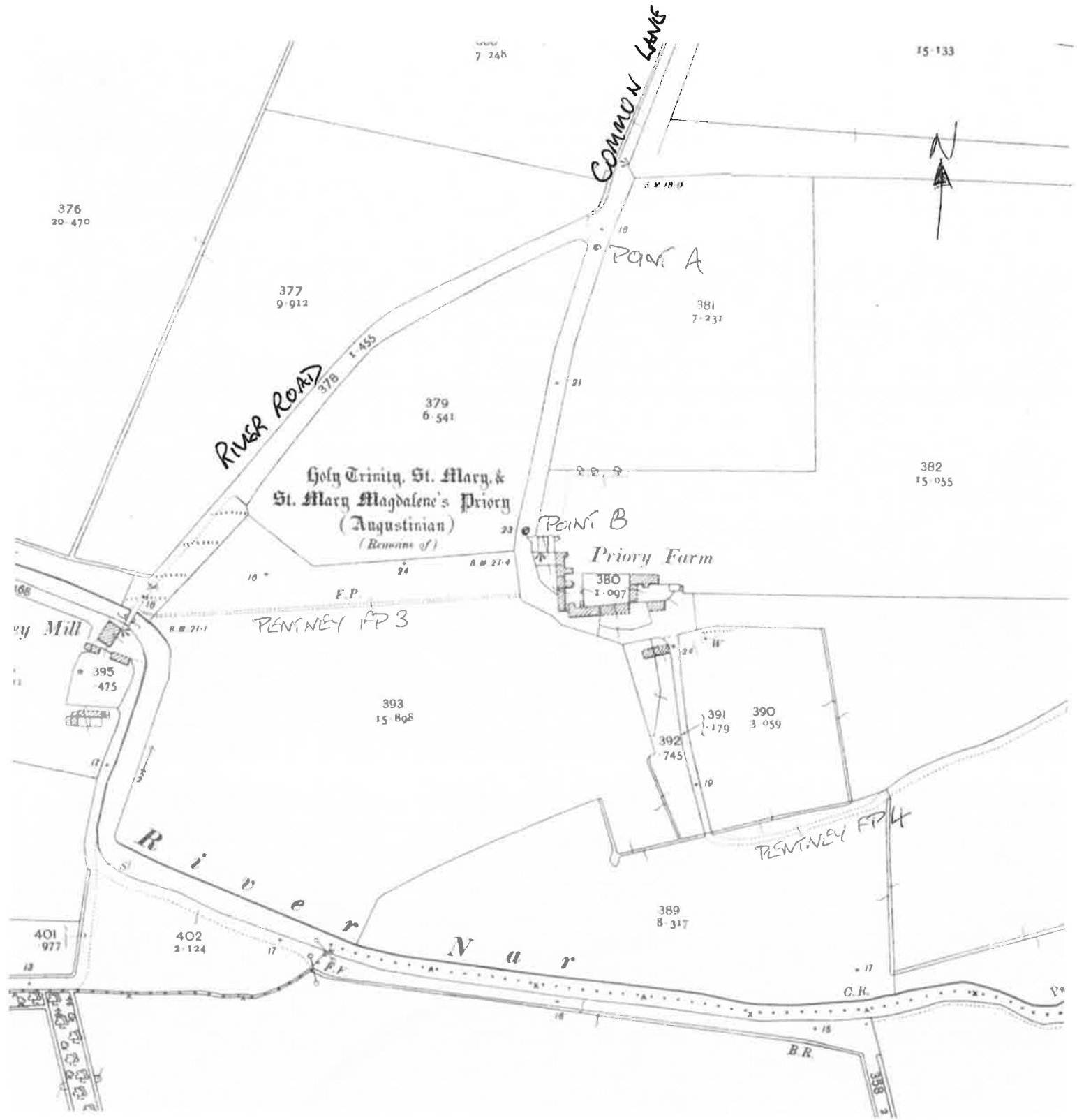

FIGURE 1. ORDNANCE SURVEY 2.5 INCH NORFOLK SHEET 46.13, 1905
 THE SPAN OF THE APPLICATION ROUTE IS BETWEEN POINT A, AT THE NORTHERN EXTENT OF THE DRIVE, WHERE IT FORMS RIVER ROAD, AND POINT B, JUST IN FRONT OF THE PENINNEY PRIOR GATEWAY. THE MAP ALSO SHOWS PENINNEY FP3 AND PENINNEY FP4. THE DEFINITIVE MAP STATUS OF THE FP BETWEEN FP3 AND FP4 WITHIN THE PRIORY GATEHOUSE COMPOUND IS UNCERTAIN AND REQUIRES CLARIFICATION.