The Norfolk County Council (Norwich Northern Distributor Road (A1067 to A47(T))) Order

2.4 Street Plans

Planning Act 2008

Infrastructure Planning

The Infrastructure Planning (Applications: Prescribed Forms and Procedure) Regulations 2009

PINS Reference Number: TR010015

Document Reference: 2.4

Regulation Number: 5(2)(k) and 5(2)(o)

Author: Persona Associates

Revision	Date	Description
0	8 th January 2014	Revision For Submission

INTRODUCTION

This document is submitted in relation to the application for a Development Consent Order by Norfolk County Council to the Secretary of State, under the Planning Act 2008.

The application is for the Norfolk County Council (Norwich Northern Distributor Road (A1067 to A47(T))) Order, to grant development consent for the construction of a new highway running west to east, to south, between the A1067 Fakenham Road and the A47 Trunk Road at Postwick, including improvements to the existing highway network to the north and north east of Norwich.

This document comprises part of the application documents and relates to Regulation 5(2)(k) and Regulation 5(2)(o) of the Infrastructure Planning (Applications: Prescribed Forms and Procedure) Regulations 2009.

SCHEDULE OF PLANS INCLUDED IN THIS DOCUMENT

Drawing No.	Drawing Title	Revision
DCO-SP-KP	Street Plans – Key Plan	0
DCO-SP-01	Street Plans (Sheet 1 of 12) Fakenham Road	0
DCO-SP-02	Street Plans (Sheet 2 of 12) Fir Covert Road to Breck Farm Lane and Marriott's Way	0
DCO-SP-03	Street Plans (Sheet 3 of 12) Reepham Road to Bell Farm Track	0
DCO-SP-04	Street Plans (Sheet 4 of 12) East of Bell Farm Track to Drayton Lane	0
DCO-SP-05	Street Plans (Sheet 5 of 12) Cromer Road Interchange to Old Norwich Road	0
DCO-SP-06	Street Plans (Sheet 6 of 12) Access to Norwich International Airport and St. Faiths Road	0

DCO-SP-07	Street Plans (Sheet 7 of 12) Buxton Road	0
DCO-SP-08	Street Plans (Sheet 8 of 12) North Walsham Road to Beeston Lane and North Walsham Road / Rackheath Lane / Crostwick Lane Junction Improvement	0
DCO-SP-09	Street Plans (Sheet 9 of 12) Wroxham Road and Wroxham Road / Green Lane West Junction Improvement	0
DCO-SP-10	Street Plans (Sheet 10 of 12) Newman Road, Salhouse Road and Railway Crossing	0
DCO-SP-11	Street Plans (Sheet 11 of 12) Plumstead Road, Middle Road and Low Road and Thorpe End Highway Improvement Measures	0
DCO-SP-12	Street Plans (Sheet 12 of 12) Smee Lane and Postwick Interchange	0

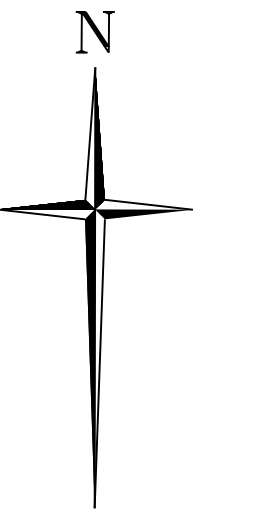

BROADLAND DISTRICT

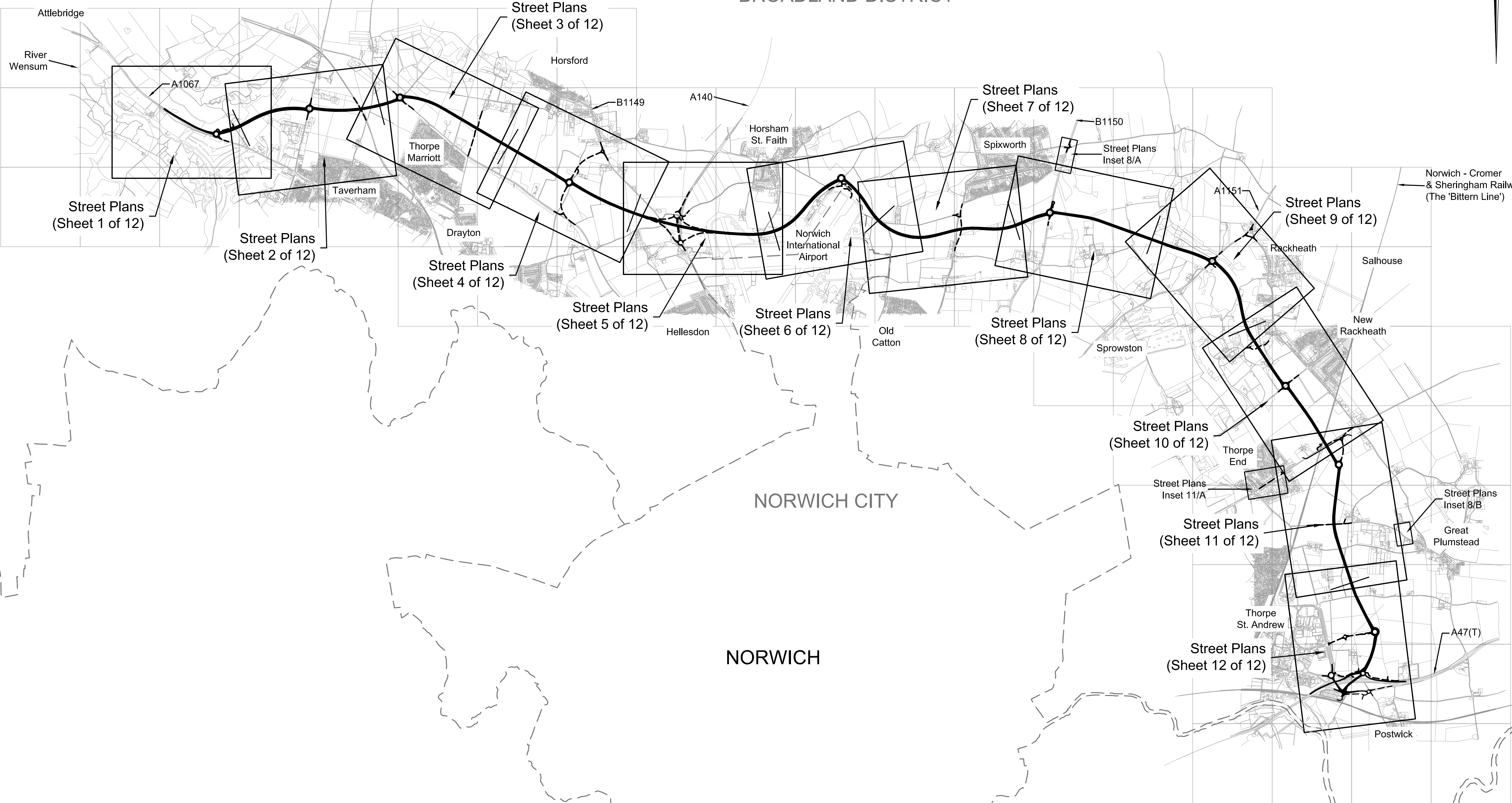

- NOTES:-
1. The Street Plans consist of twelve individual sheets covering the length of the scheme, plus a key plan.
 2. The Street Plans are based on the Ordnance Survey mapping and are orientated to the Great Britain National Grid.
 3. The Street Plans should be read in conjunction with the Development Consent Order.

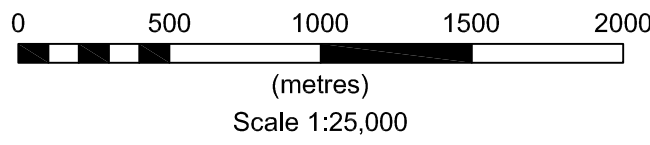

Author: PERSONA ASSOCIATES		
Scheme Title: NORWICH NORTHERN DISTRIBUTOR ROAD		
Plan Title: STREET PLANS		
KEY PLAN		
Plan Number: DCO-SP-KP	Plan Revision: 0	Plan Date: December 2013
Regulation: Regulations 5(2)(k) and 5(2)(o)		

G:\COMMISSION DIRECT\ORIS\Norwich Distributor Road - 23062\CAUDCO Streets\Norwich DCO\SP-KP.dwg

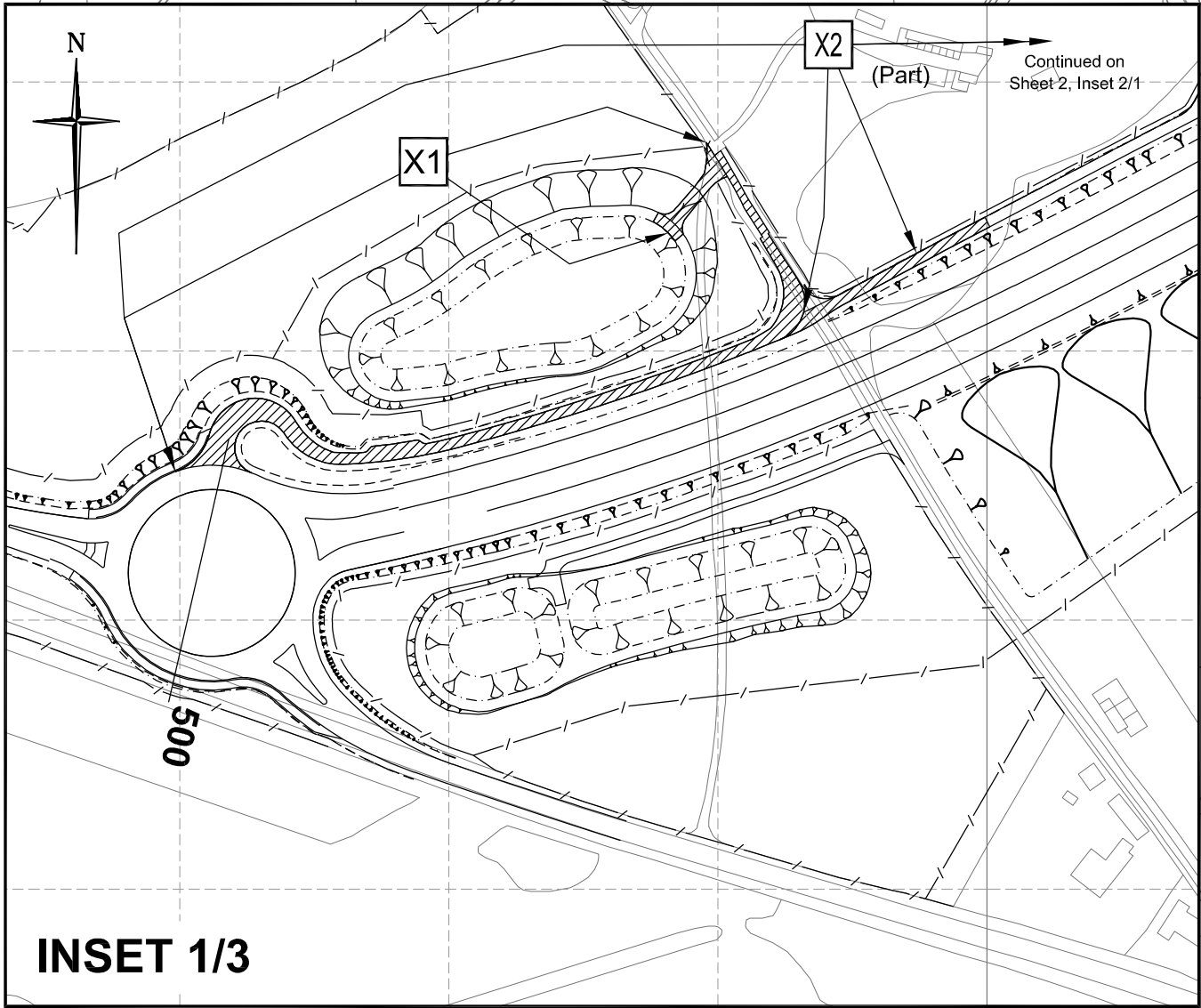
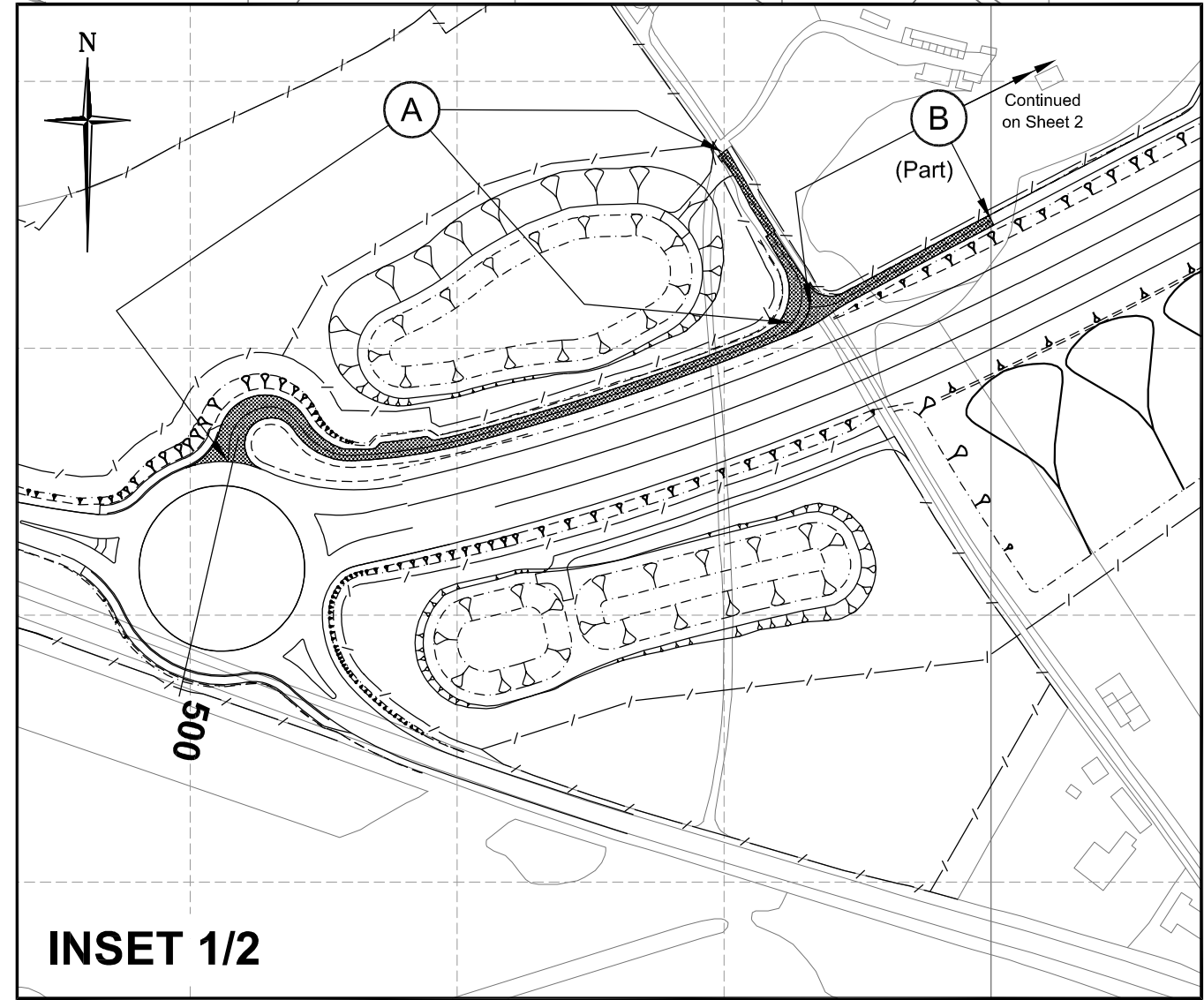
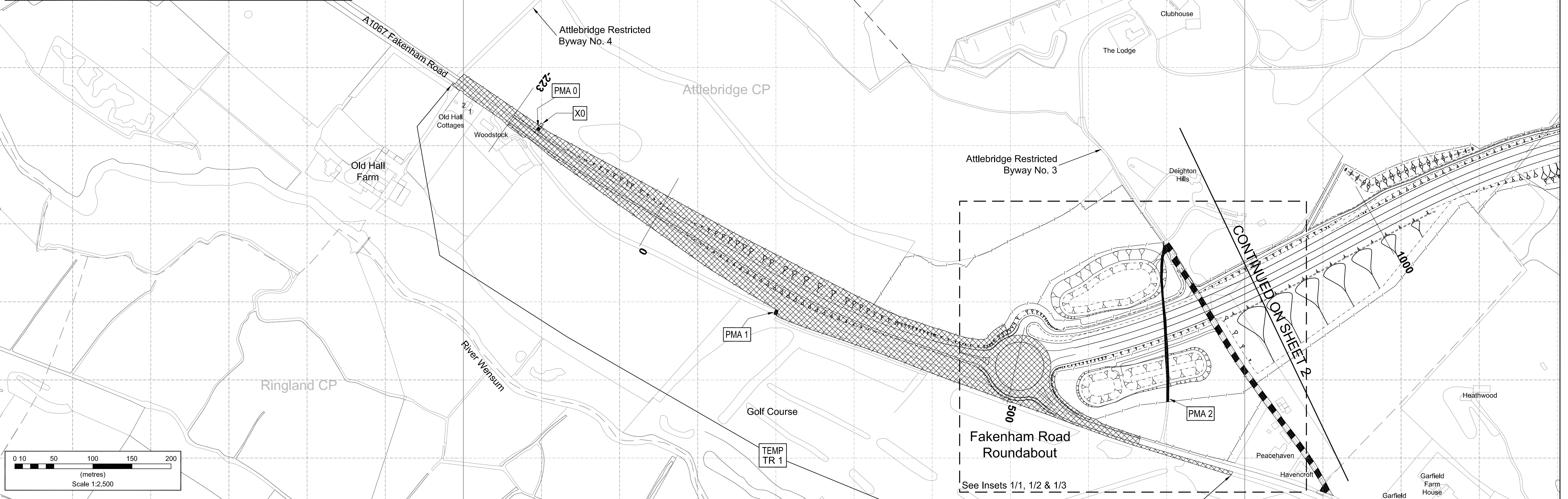
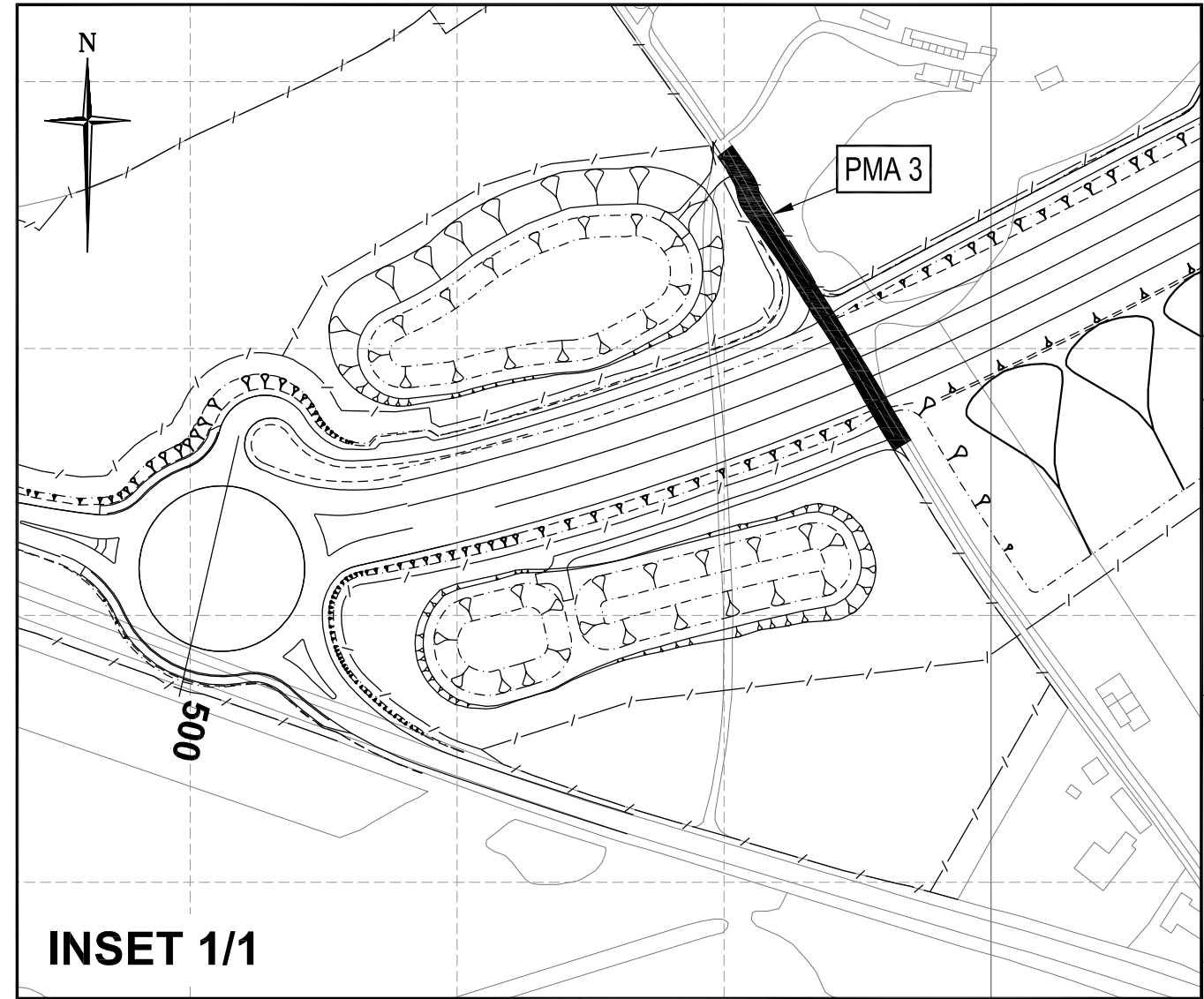

NOTES:-

1. The Street Plans consist of twelve individual sheets covering the length of the scheme, plus a key plan.
2. The Street Plans are based on the Ordnance Survey mapping and are orientated to the Great Britain National Grid. Co-ordinates are absolute and are given in metres.
3. The Street Plans should be read in conjunction with the Development Consent Order.

PLAN SYMBOLS:-	
	THE NDR CLASSIFIED ROAD
	THE NEW A47 TRUNK ROAD
	POSTWICK INTERCHANGE SLIP ROADS
	ROUTE OF NEW HIGHWAY
	HIGHWAY TO BE IMPROVED
	HIGHWAY TO BE STOPPED UP
	ROUTE OF NEW PRIVATE MEANS OF ACCESS
	PRIVATE MEANS OF ACCESS TO BE STOPPED UP
	EXTENT OF TEMPORARY TRAFFIC REGULATION MEASURES

Author: PERSONA ASSOCIATES		
Scheme Title: NORWICH NORTHERN DISTRIBUTOR ROAD		
Plan Title: STREET PLANS (SHEET 1 OF 12)		
Plan Number: DCO-SP-01		
Plan Revision: 0		
Plan Date: December 2013		
Regulation: Regulations 5(2)(k) and 5(2)(o)		

- NOTES:-
1. The Street Plans consist of twelve individual sheets covering the length of the scheme, plus a key plan.
 2. The Street Plans are based on the Ordnance Survey mapping and are orientated to the Great Britain National Grid. Co-ordinates are absolute and are given in metres.
 3. The Street Plans should be read in conjunction with the Development Consent Order.

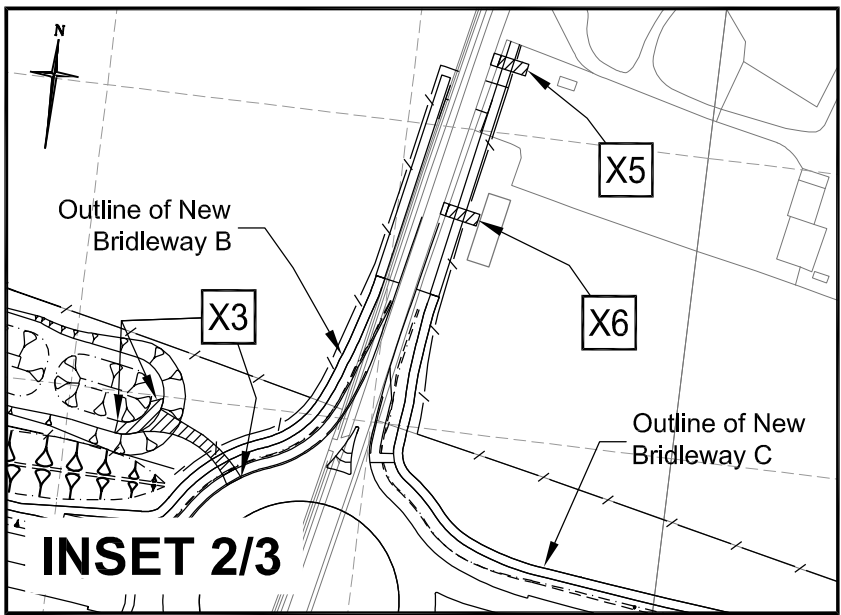
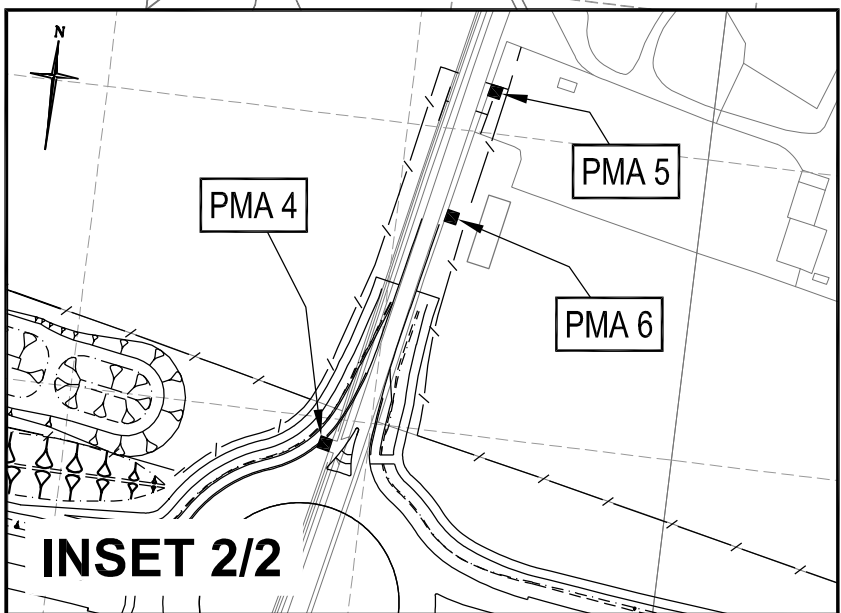
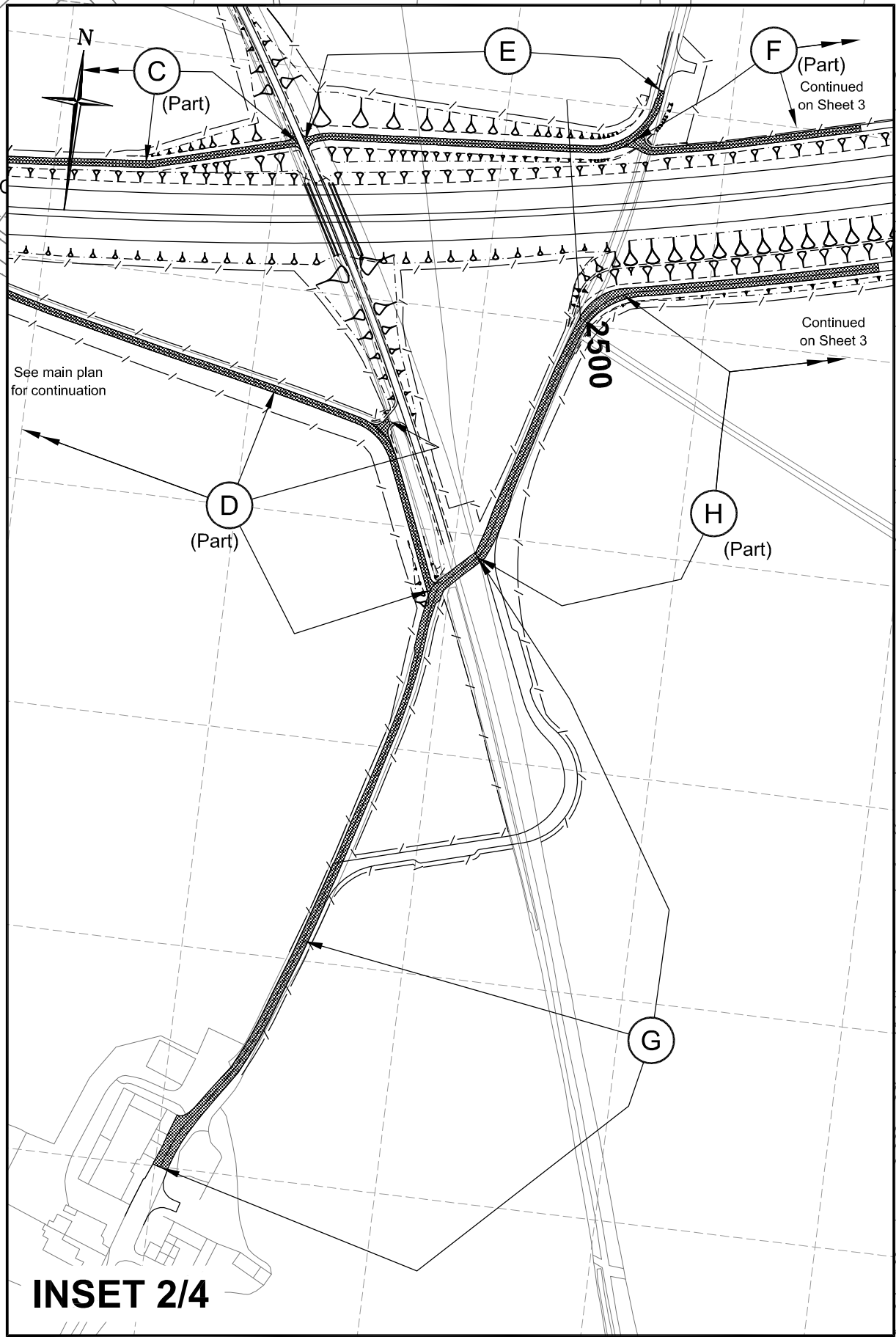
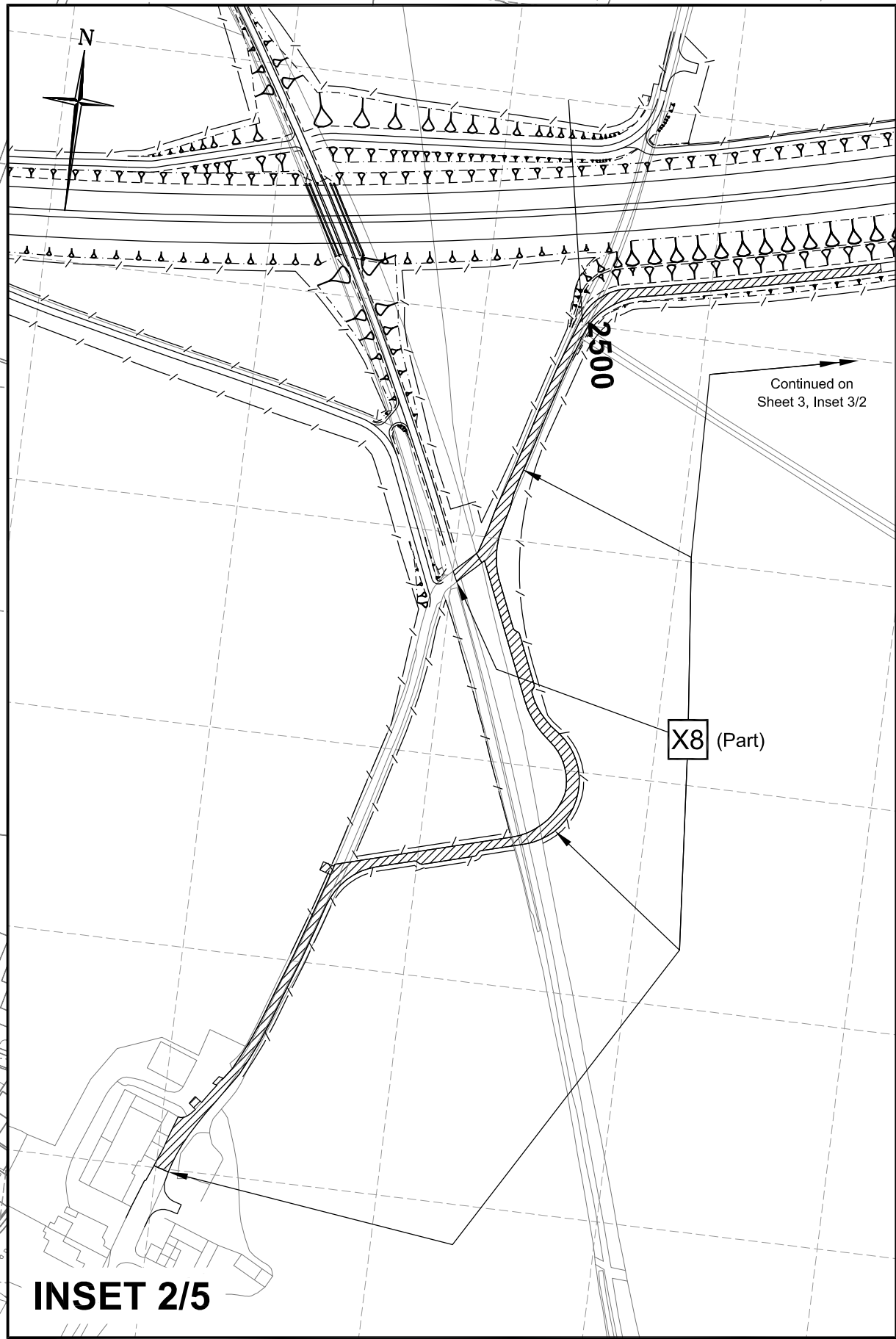
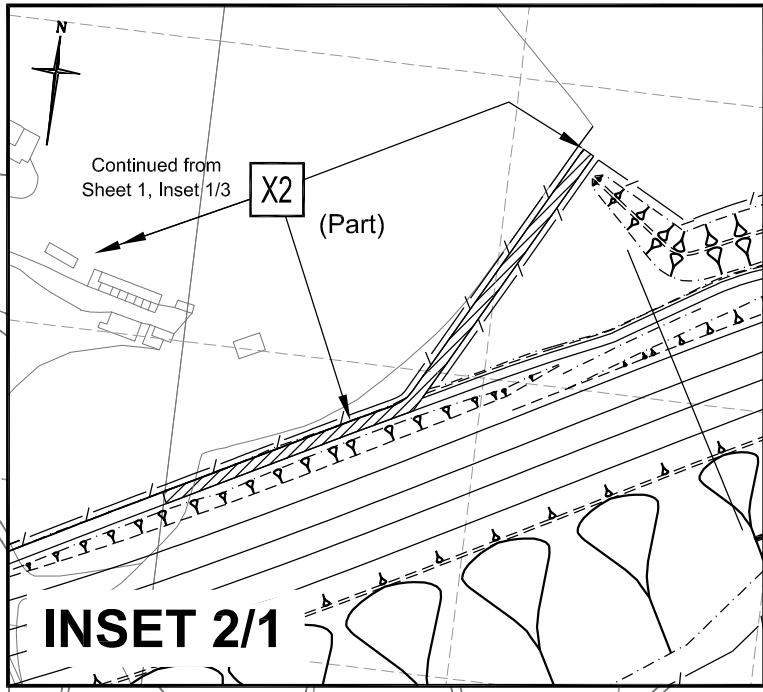
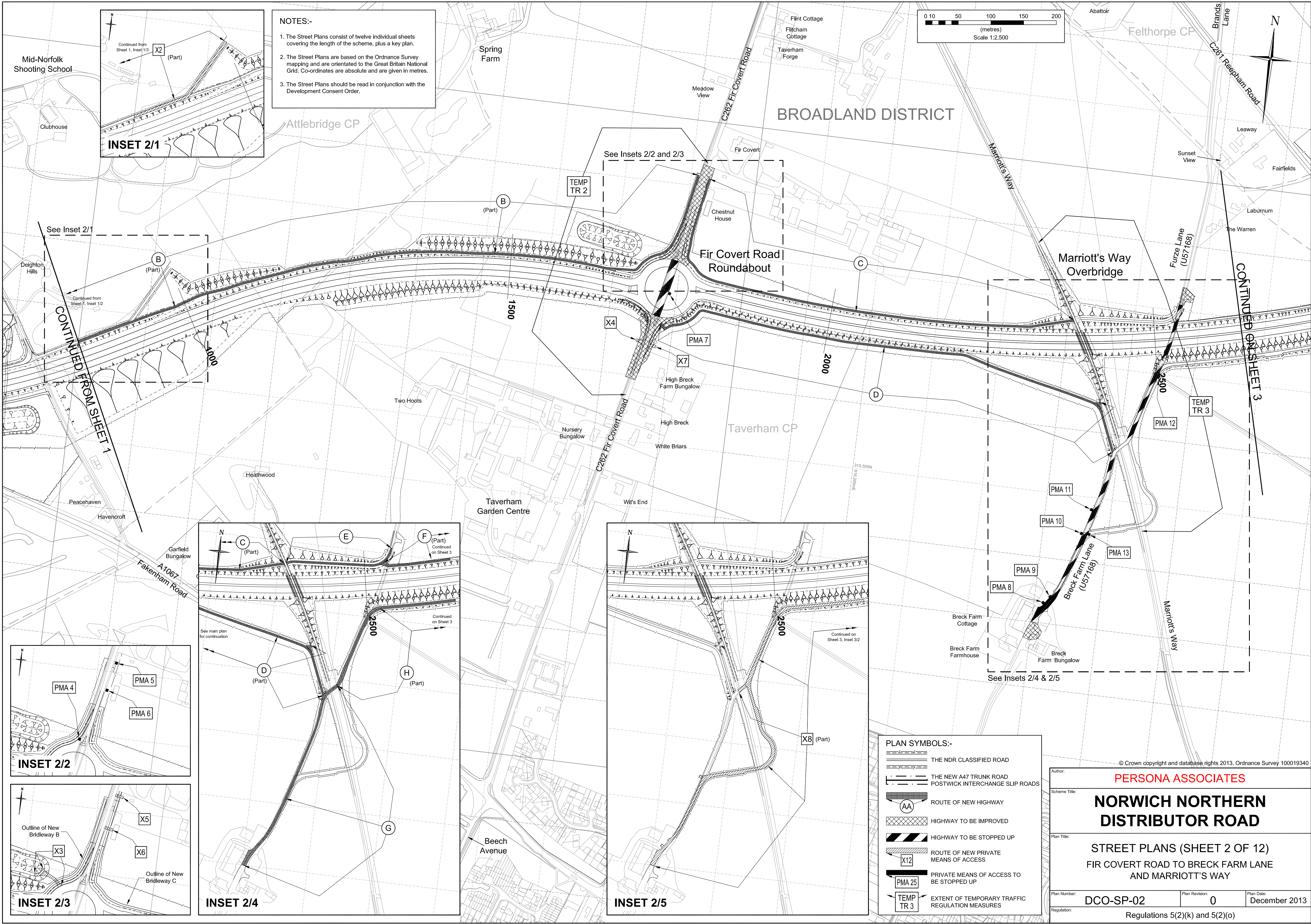
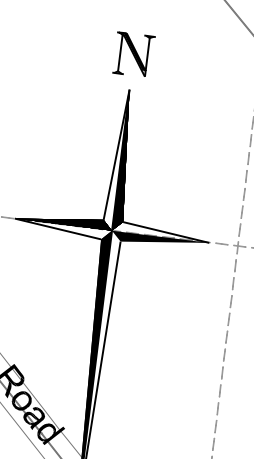
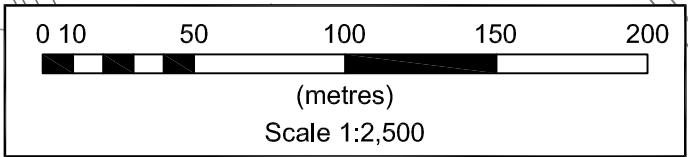

- PLAN SYMBOLS:-
- THE NDR CLASSIFIED ROAD
 - THE NEW A47 TRUNK ROAD POSTWICK INTERCHANGE SLIP ROADS
 - ROUTE OF NEW HIGHWAY
 - HIGHWAY TO BE IMPROVED
 - HIGHWAY TO BE STOPPED UP
 - ROUTE OF NEW PRIVATE MEANS OF ACCESS
 - PRIVATE MEANS OF ACCESS TO BE STOPPED UP
 - EXTENT OF TEMPORARY TRAFFIC REGULATION MEASURES

Author: PERSONA ASSOCIATES

Scheme Title: NORWICH NORTHERN DISTRIBUTOR ROAD

Plan Title: STREET PLANS (SHEET 2 OF 12)
FIR COVERT ROAD TO BRECK FARM LANE AND MARRIOTT'S WAY

Plan Number: DCO-SP-02 Plan Revision: 0 Plan Date: December 2013

Regulation: Regulations 5(2)(k) and 5(2)(o)

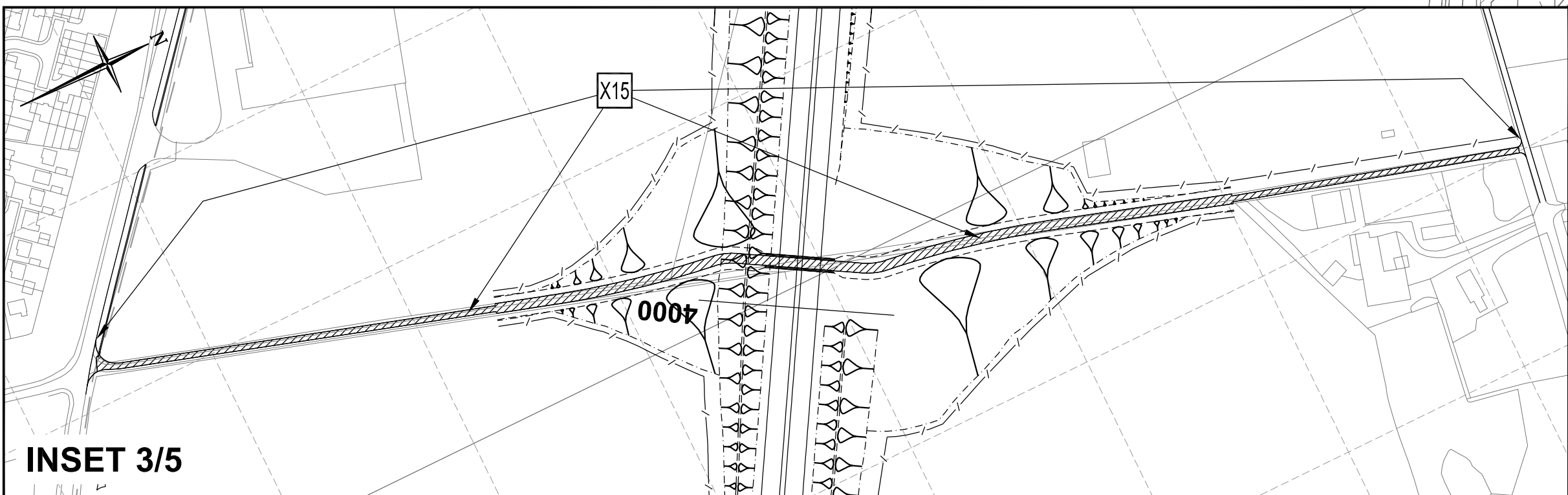
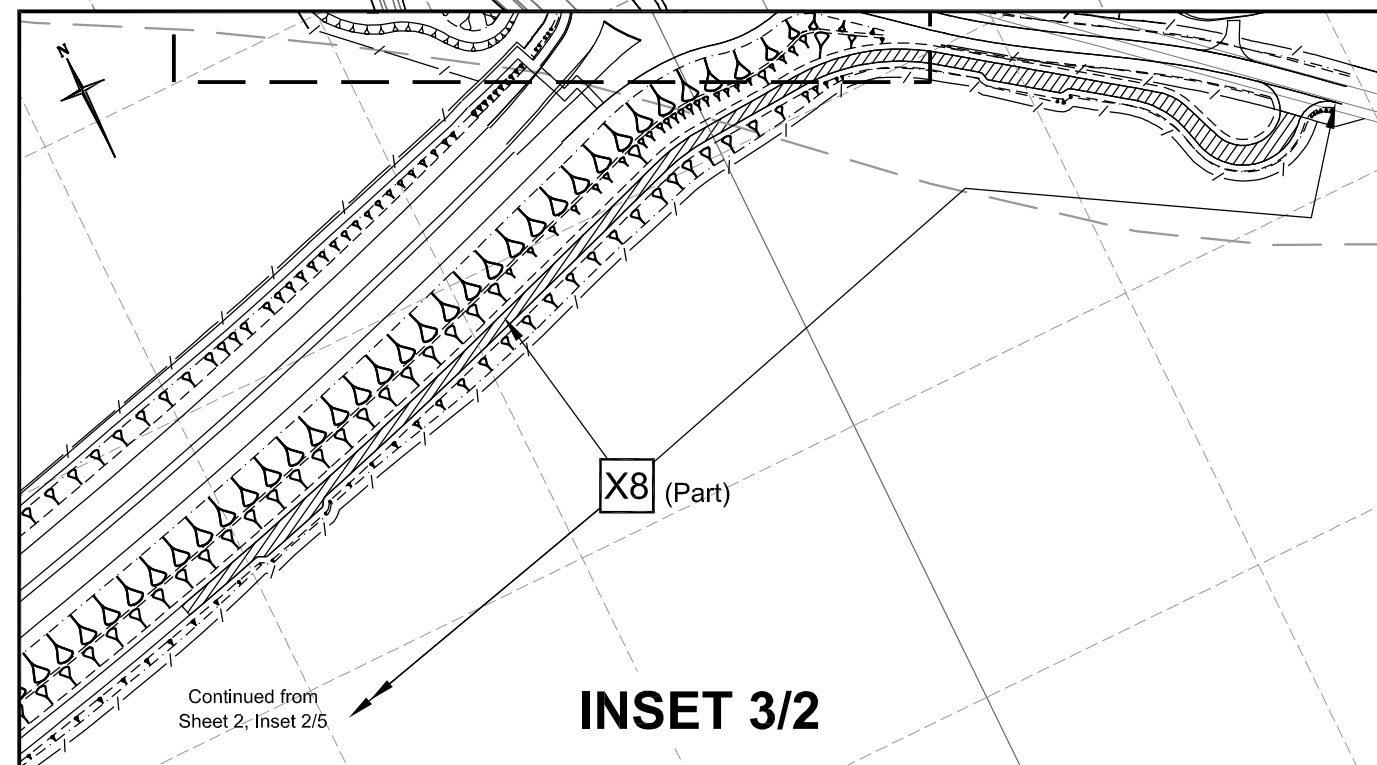
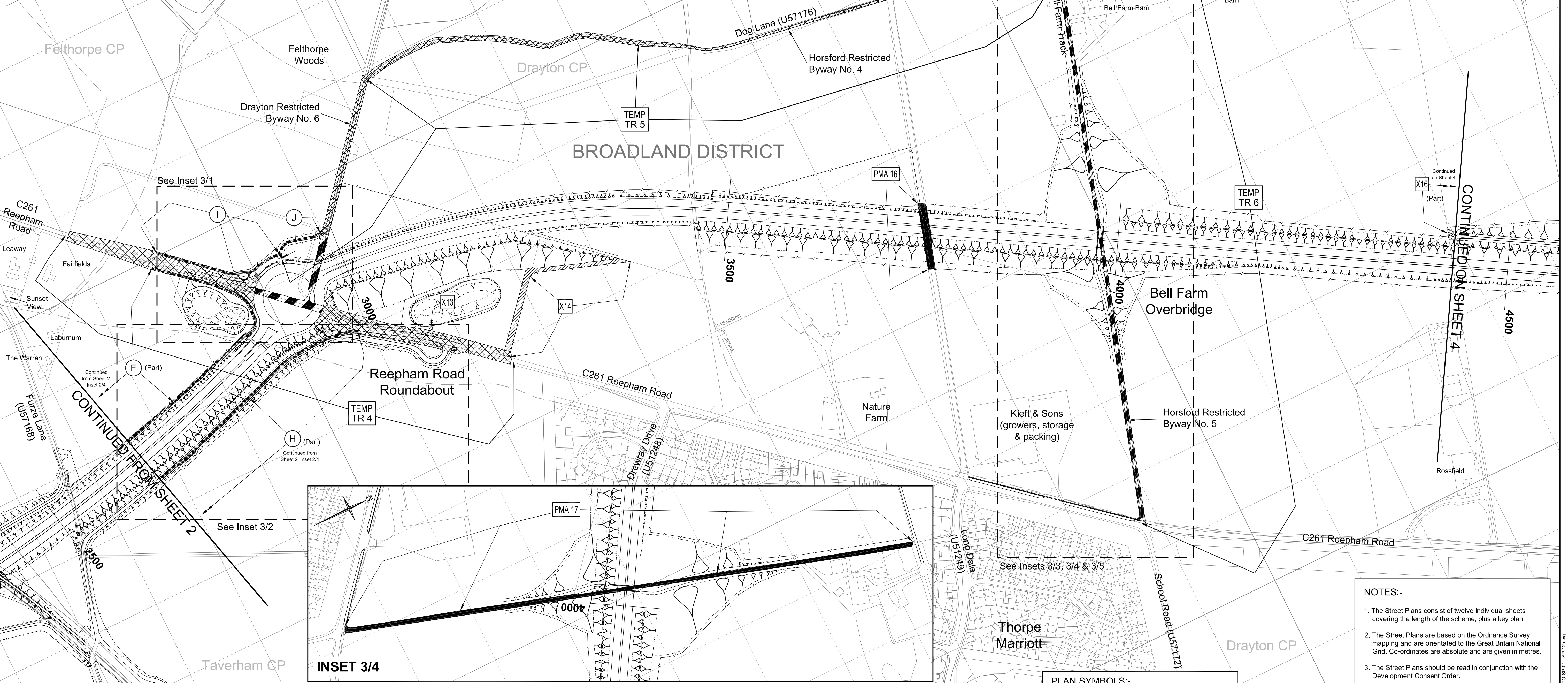
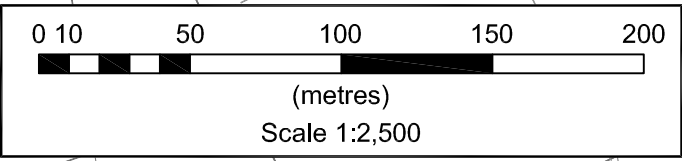
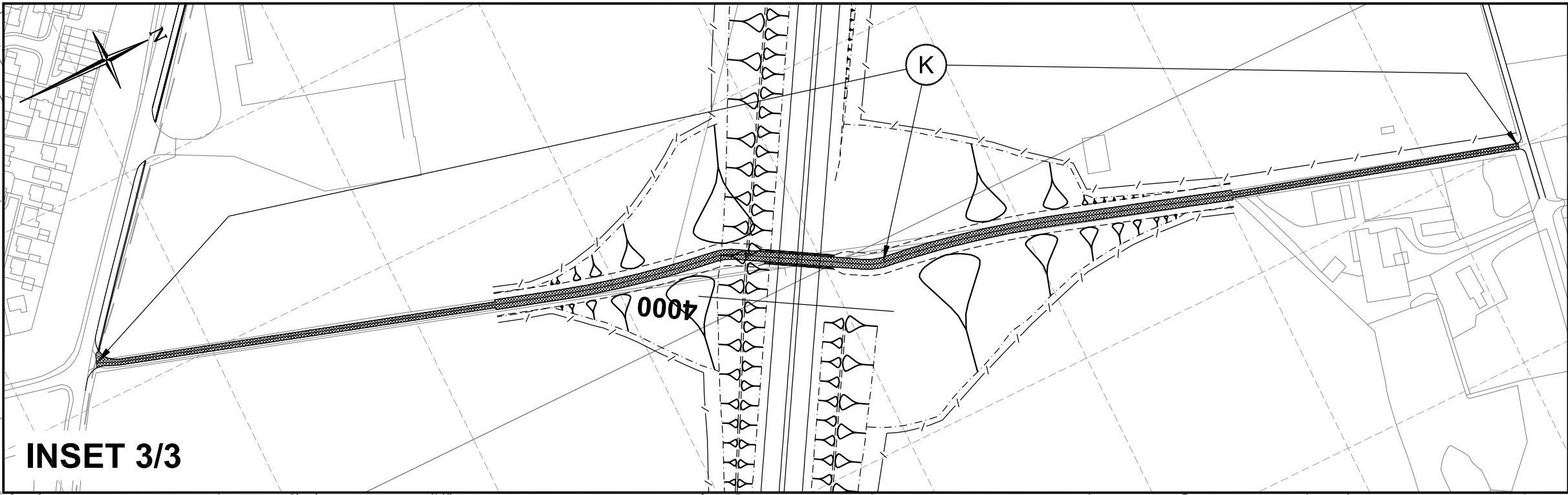
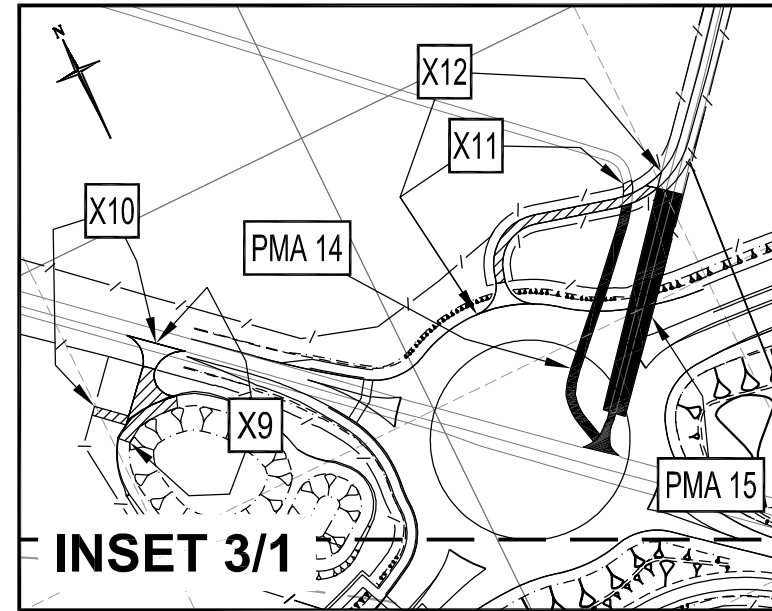

PLAN SYMBOLS:-	
	THE NDR CLASSIFIED ROAD
	THE NEW A47 TRUNK ROAD POSTWORK INTERCHANGE SLIP ROADS
	ROUTE OF NEW HIGHWAY
	HIGHWAY TO BE IMPROVED
	HIGHWAY TO BE STOPPED UP
	ROUTE OF NEW PRIVATE MEANS OF ACCESS
	PRIVATE MEANS OF ACCESS TO BE STOPPED UP
	EXTENT OF TEMPORARY TRAFFIC REGULATION MEASURES

NOTES:-

1. The Street Plans consist of twelve individual sheets covering the length of the scheme, plus a key plan.
2. The Street Plans are based on the Ordnance Survey mapping and are orientated to the Great Britain National Grid. Co-ordinates are absolute and are given in metres.
3. The Street Plans should be read in conjunction with the Development Consent Order.

© Crown copyright and database rights 2013. Ordnance Survey 100019340

PERSONA ASSOCIATES

NORWICH NORTHERN DISTRIBUTOR ROAD

STREET PLANS (SHEET 3 OF 12)

REEPHAM ROAD TO BELL FARM TRACK

Author:	PERSONA ASSOCIATES	
Scheme Title:	NORWICH NORTHERN DISTRIBUTOR ROAD	
Plan Title:	STREET PLANS (SHEET 3 OF 12)	
Plan Number:	DCO-SP-03	Plan Revision: 0
Regulation:	Regulations 5(2)(k) and 5(2)(o)	
Plan Date:	December 2013	

G:\COMMISSION DIRECTOR\NORWICH\Norwich Distributor Road - 2486 CAD\DCO Street Plans\DCO-SP-03-1 - SP-12.dwg

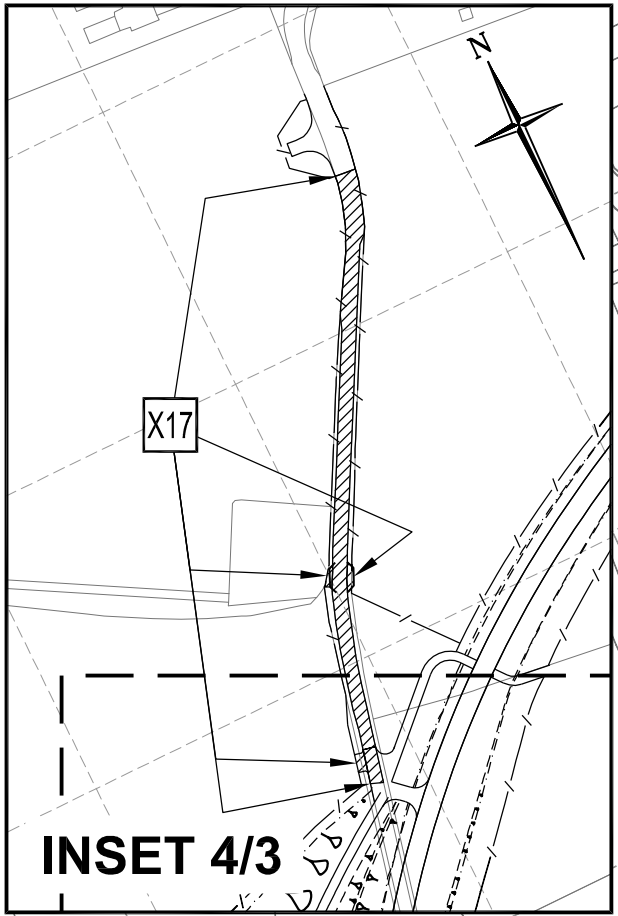
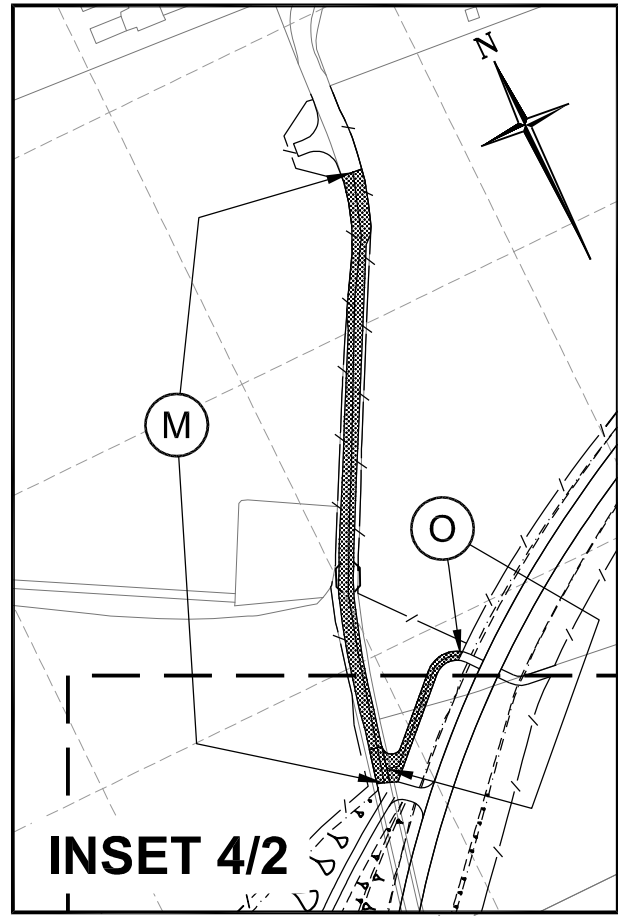
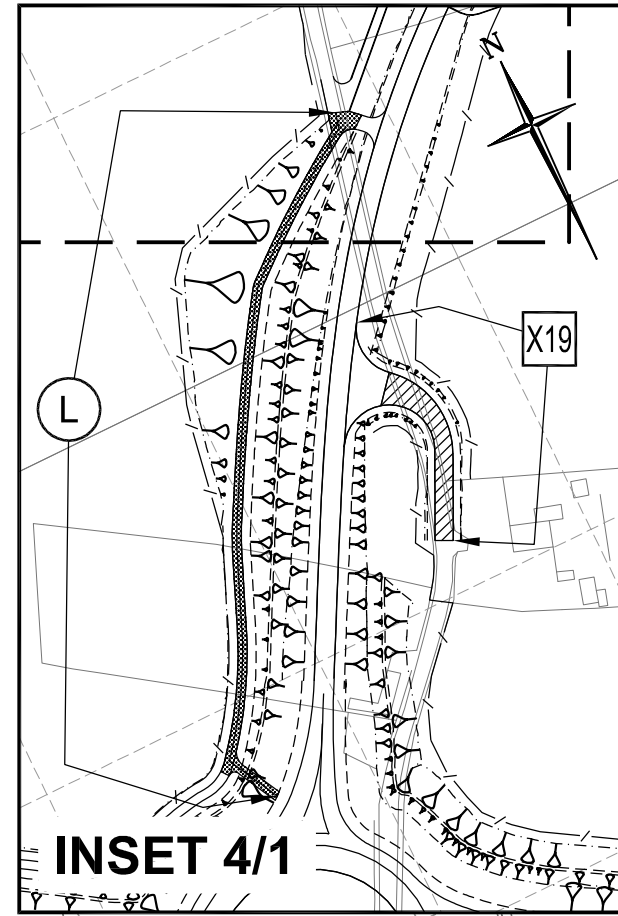

- NOTES:-
1. The Street Plans consist of twelve individual sheets covering the length of the scheme, plus a key plan.
 2. The Street Plans are based on the Ordnance Survey mapping and are orientated to the Great Britain National Grid. Co-ordinates are absolute and are given in metres.
 3. The Street Plans should be read in conjunction with the Development Consent Order.

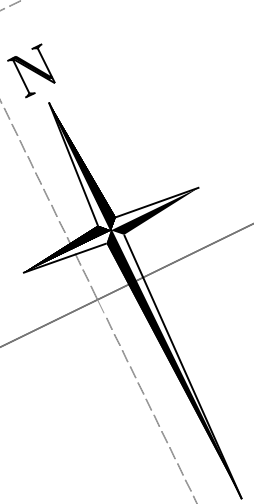

BROADLAND DISTRICT

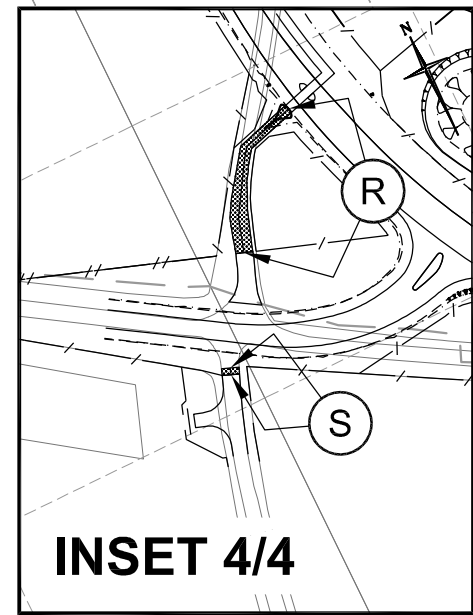
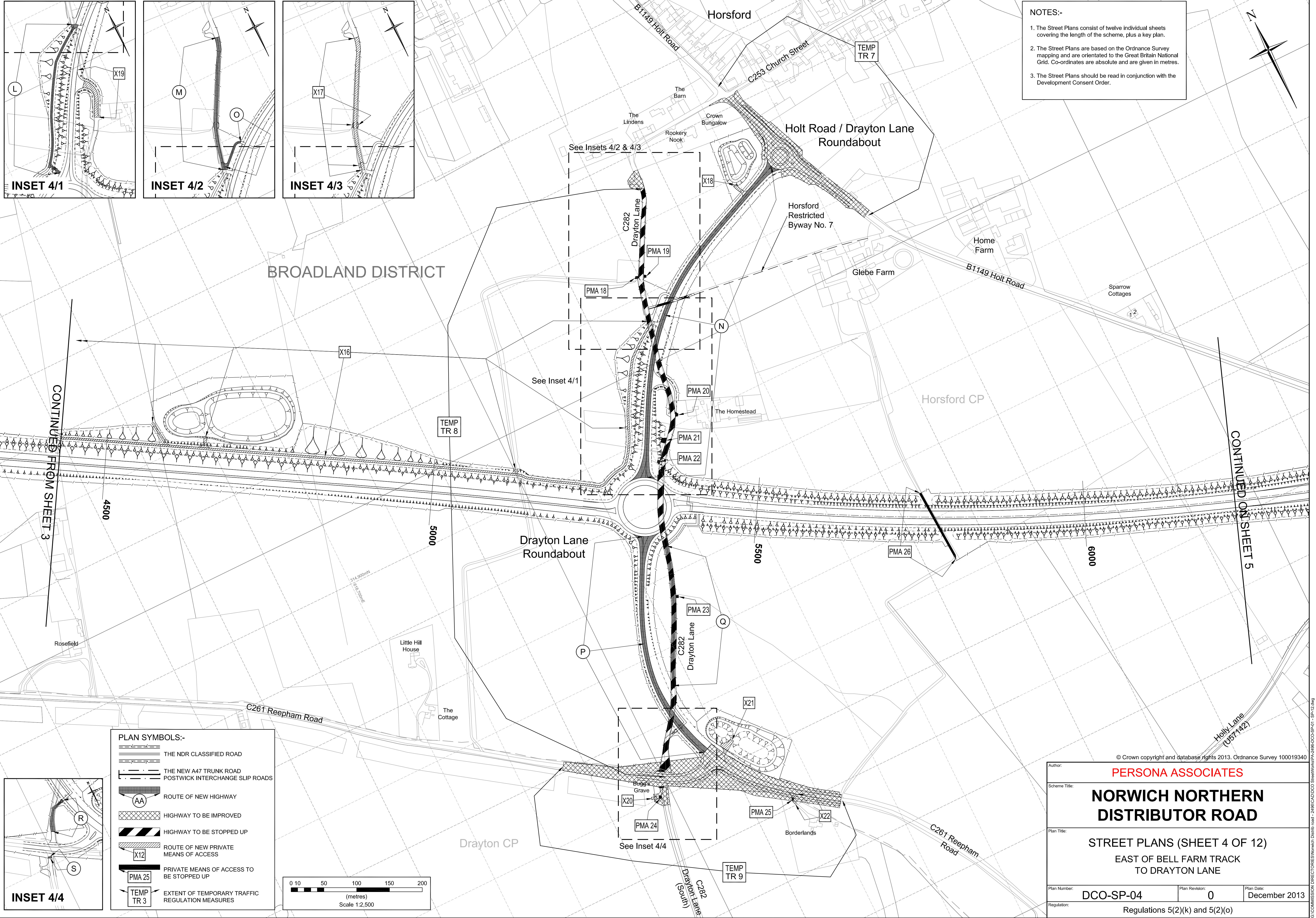

- PLAN SYMBOLS:-
- THE NDR CLASSIFIED ROAD
 - THE NEW A47 TRUNK ROAD POSTWICK INTERCHANGE SLIP ROADS
 - ROUTE OF NEW HIGHWAY
 - HIGHWAY TO BE IMPROVED
 - HIGHWAY TO BE STOPPED UP
 - ROUTE OF NEW PRIVATE MEANS OF ACCESS
 - PRIVATE MEANS OF ACCESS TO BE STOPPED UP
 - EXTENT OF TEMPORARY TRAFFIC REGULATION MEASURES

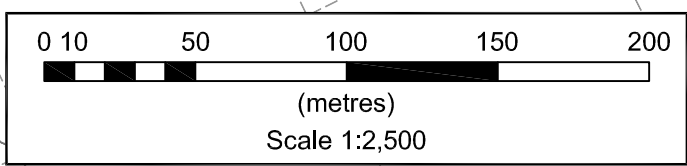

Author: PERSONA ASSOCIATES		
Scheme Title: NORWICH NORTHERN DISTRIBUTOR ROAD		
Plan Title: STREET PLANS (SHEET 4 OF 12) EAST OF BELL FARM TRACK TO DRAYTON LANE		
Plan Number: DCO-SP-04	Plan Revision: 0	Plan Date: December 2013
Regulation: Regulations 5(2)(k) and 5(2)(o)		

G:\COMMISSION DIRECTOR\NORWICH\NDR\DCO\SP\04\DCO-SP-04-1-SP-4-2.dwg

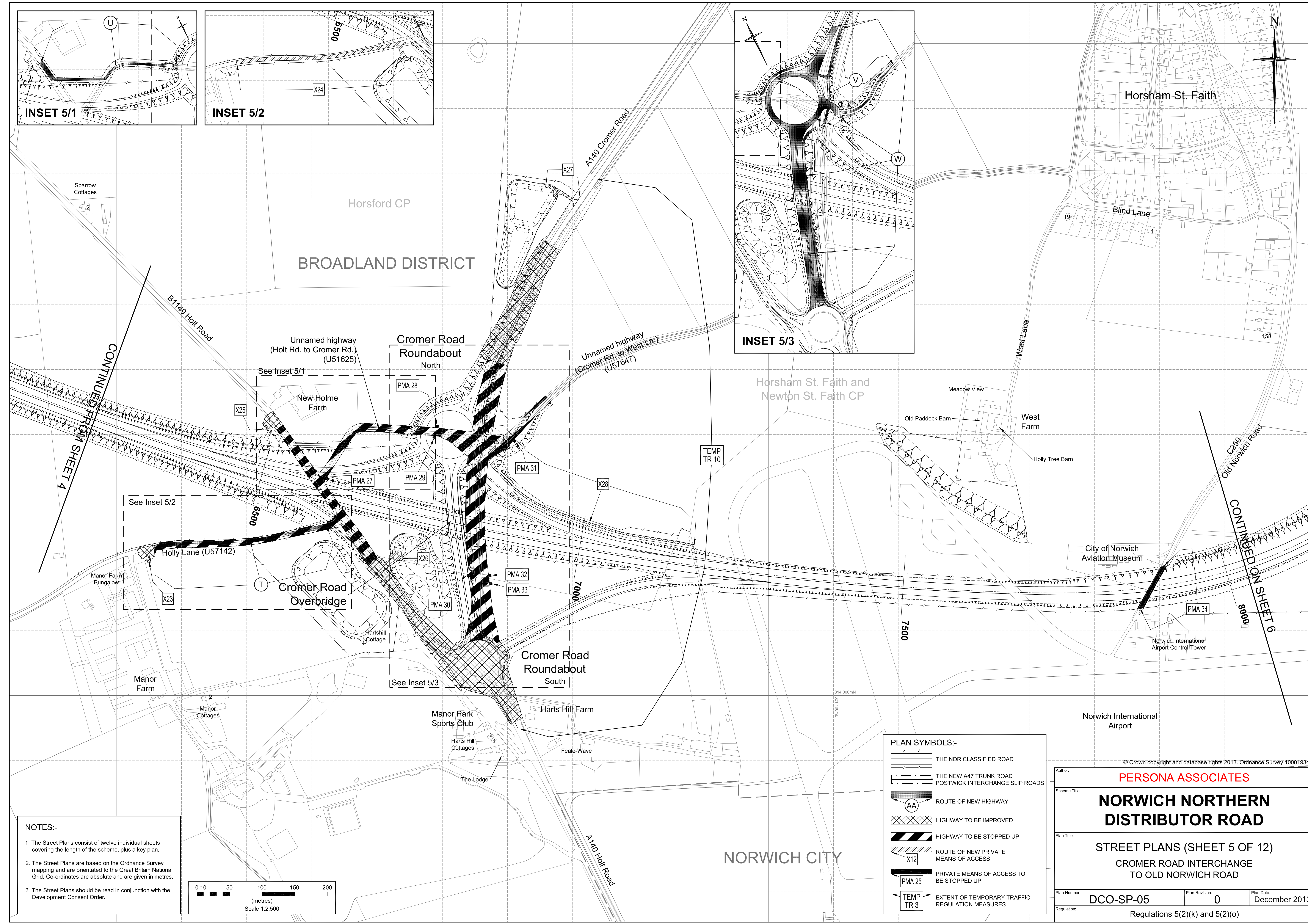
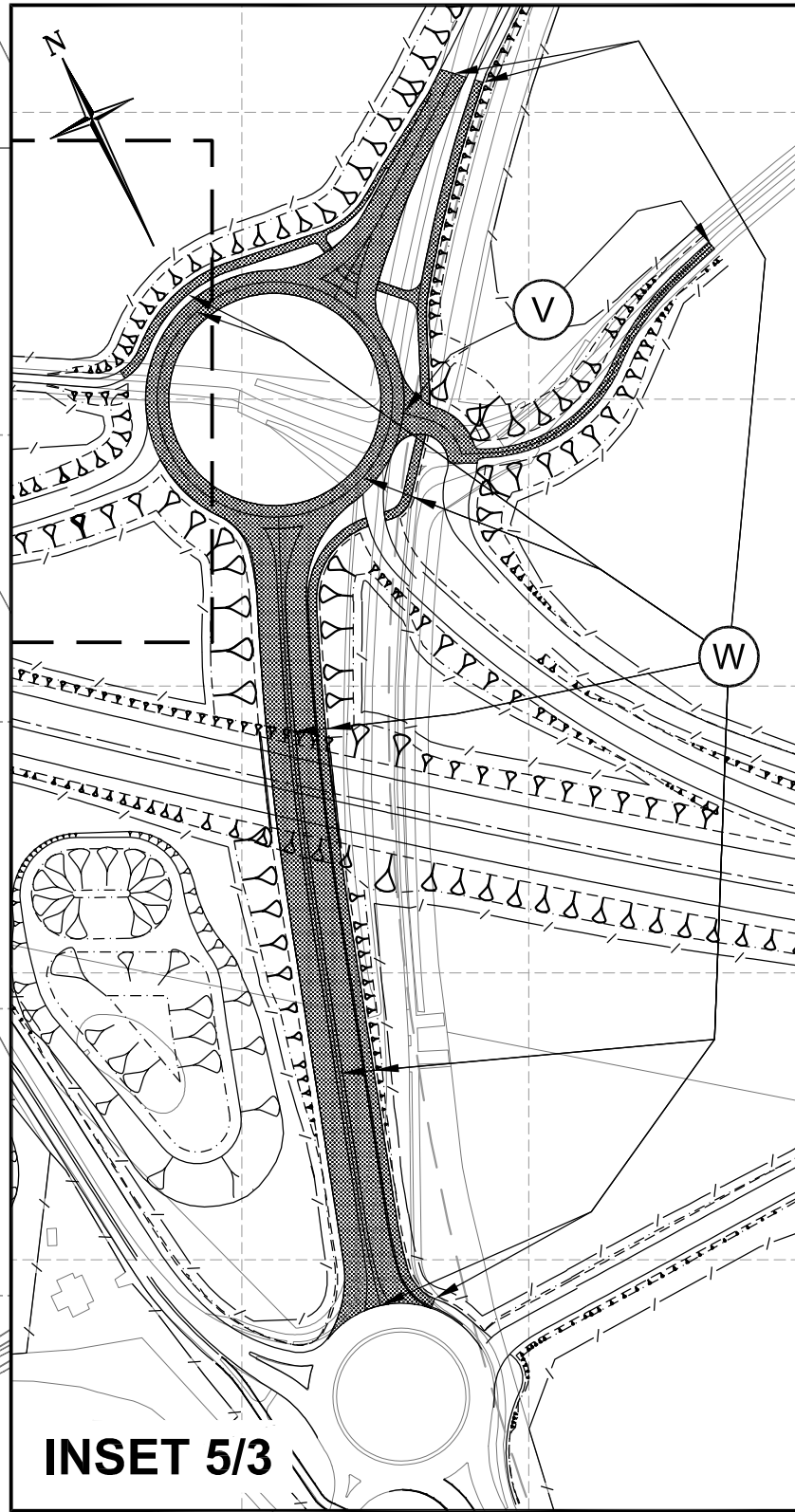
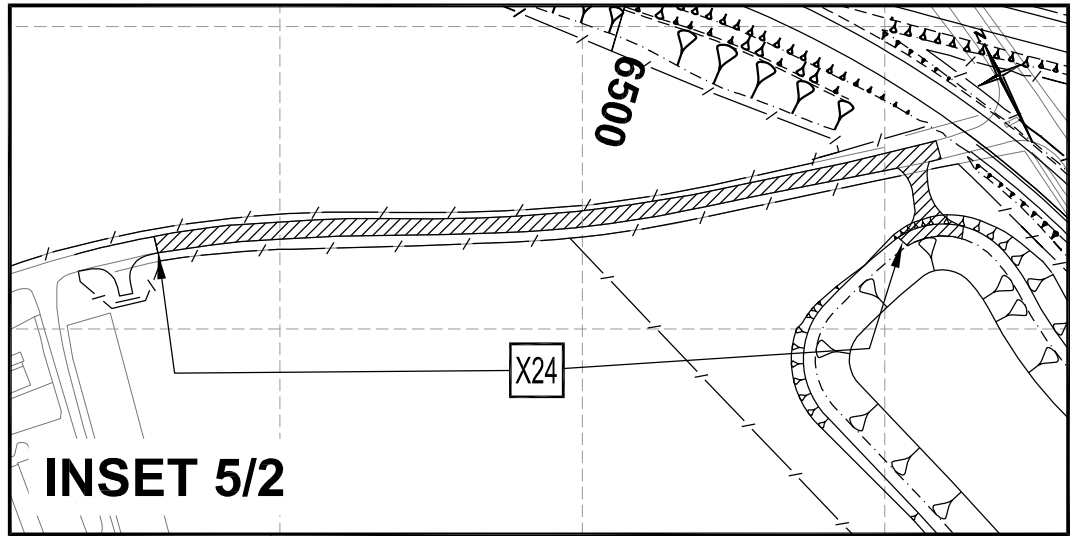
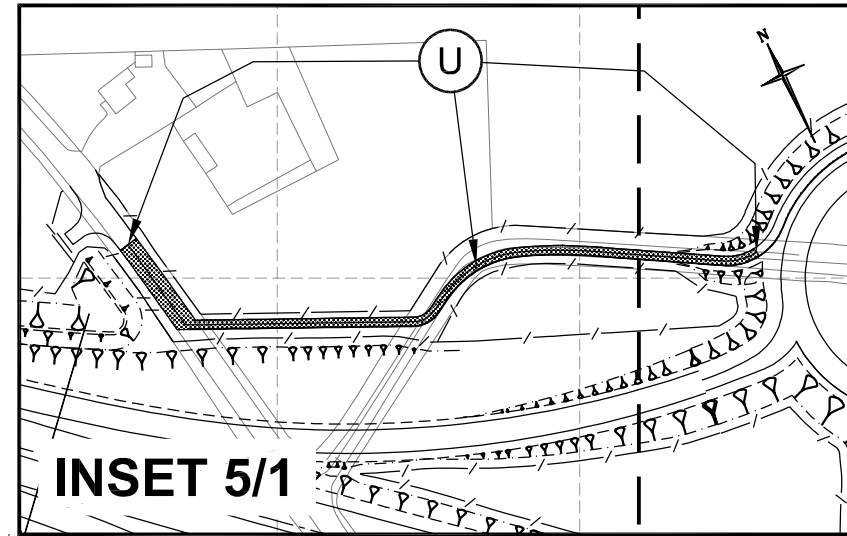

- NOTES:-**
1. The Street Plans consist of twelve individual sheets covering the length of the scheme, plus a key plan.
 2. The Street Plans are based on the Ordnance Survey mapping and are orientated to the Great Britain National Grid. Co-ordinates are absolute and are given in metres.
 3. The Street Plans should be read in conjunction with the Development Consent Order.

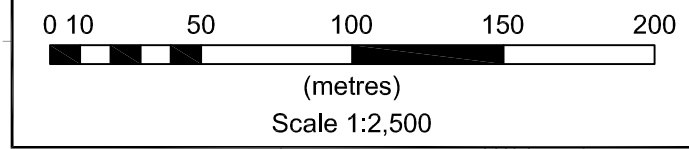

PLAN SYMBOLS:-	
	THE NDR CLASSIFIED ROAD
	THE NEW A47 TRUNK ROAD POSTWICK INTERCHANGE SLIP ROADS
	ROUTE OF NEW HIGHWAY
	HIGHWAY TO BE IMPROVED
	HIGHWAY TO BE STOPPED UP
	ROUTE OF NEW PRIVATE MEANS OF ACCESS
	PRIVATE MEANS OF ACCESS TO BE STOPPED UP
	EXTENT OF TEMPORARY TRAFFIC REGULATION MEASURES

© Crown copyright and database rights 2013. Ordnance Survey 100019340		
Author:	PERSONA ASSOCIATES	
Scheme Title:	NORWICH NORTHERN DISTRIBUTOR ROAD	
Plan Title:	STREET PLANS (SHEET 5 OF 12) CROMER ROAD INTERCHANGE TO OLD NORWICH ROAD	
Plan Number:	DCO-SP-05	Plan Date: December 2013
Regulation:	Regulations 5(2)(k) and 5(2)(o)	

G:\COMMISSION DIRECTOR\NORWICH\NORWICH Distrib road - 2486 CAD\DCO StreetWorks\PS\DCO-SP-05-01 - SP-5-2.dwg

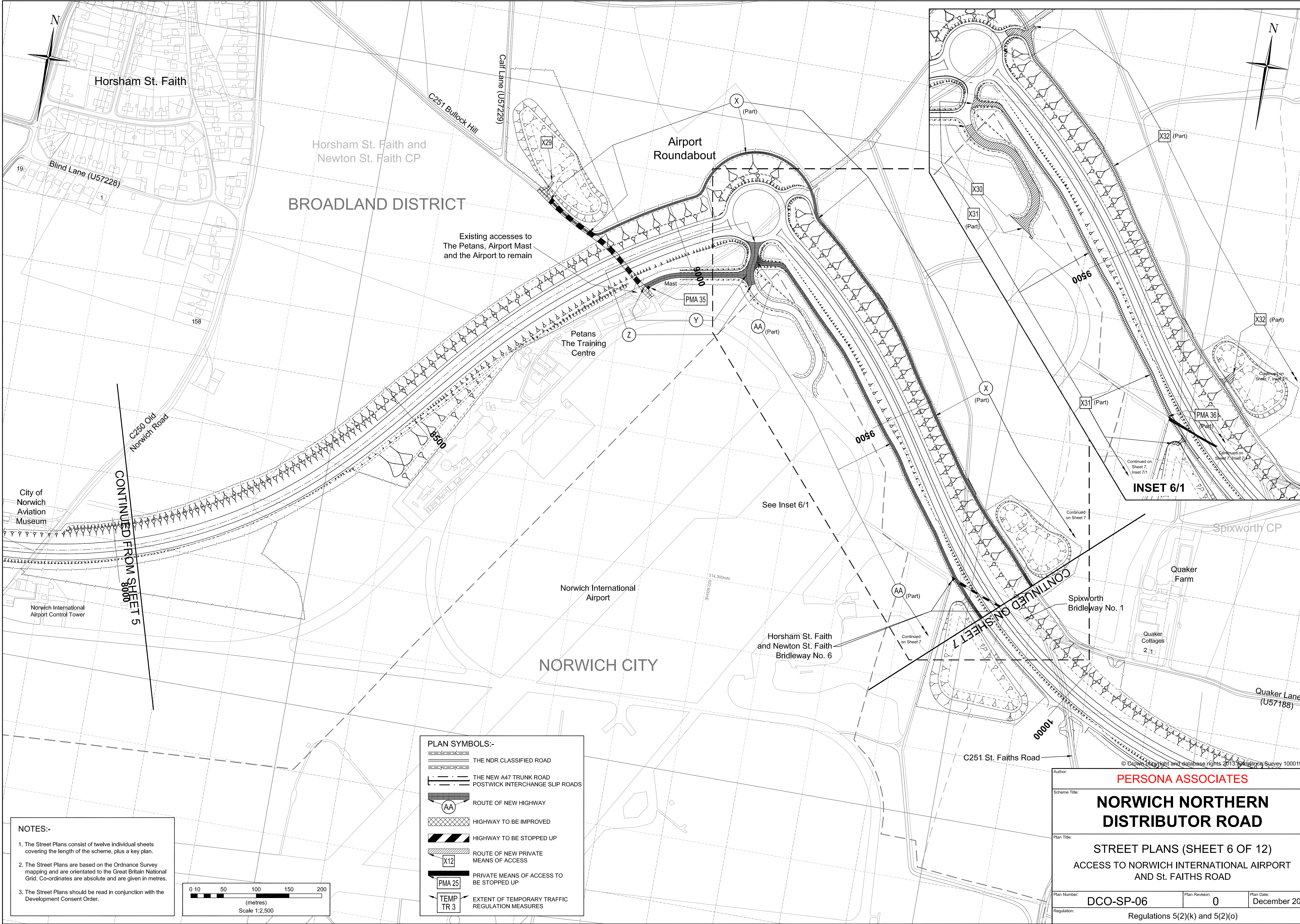

PLAN SYMBOLS:-

	THE NDR CLASSIFIED ROAD
	THE NEW A47 TRUNK ROAD POSTTACK INTERCHANGE SLIP ROADS
	ROUTE OF NEW HIGHWAY
	HIGHWAY TO BE IMPROVED
	HIGHWAY TO BE STOPPED UP
	ROUTE OF NEW PRIVATE MEANS OF ACCESS
	PRIVATE MEANS OF ACCESS TO BE STOPPED UP
	EXTENT OF TEMPORARY TRAFFIC REGULATION MEASURES

- NOTES:-**
- The Street Plans consist of twelve individual sheets covering the length of the scheme, plus a key plan.
 - The Street Plans are based on the Ordnance Survey mapping and are orientated to the Great Britain National Grid. Co-ordinates are absolute and are given in metres.
 - The Street Plans should be read in conjunction with the Development Consent Order.

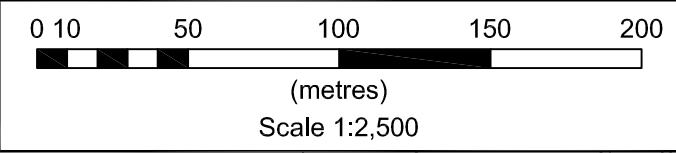

Author: **PERSONA ASSOCIATES**

Scheme Title: **NORWICH NORTHERN DISTRIBUTOR ROAD**

Plan Title: **STREET PLANS (SHEET 6 OF 12)**
ACCESS TO NORWICH INTERNATIONAL AIRPORT AND St. FAITHS ROAD

Plan Number: DCO-SP-06	Plan Revision: 0	Plan Date: December 2013
Regulation: Regulations 5(2)(k) and 5(2)(o)		

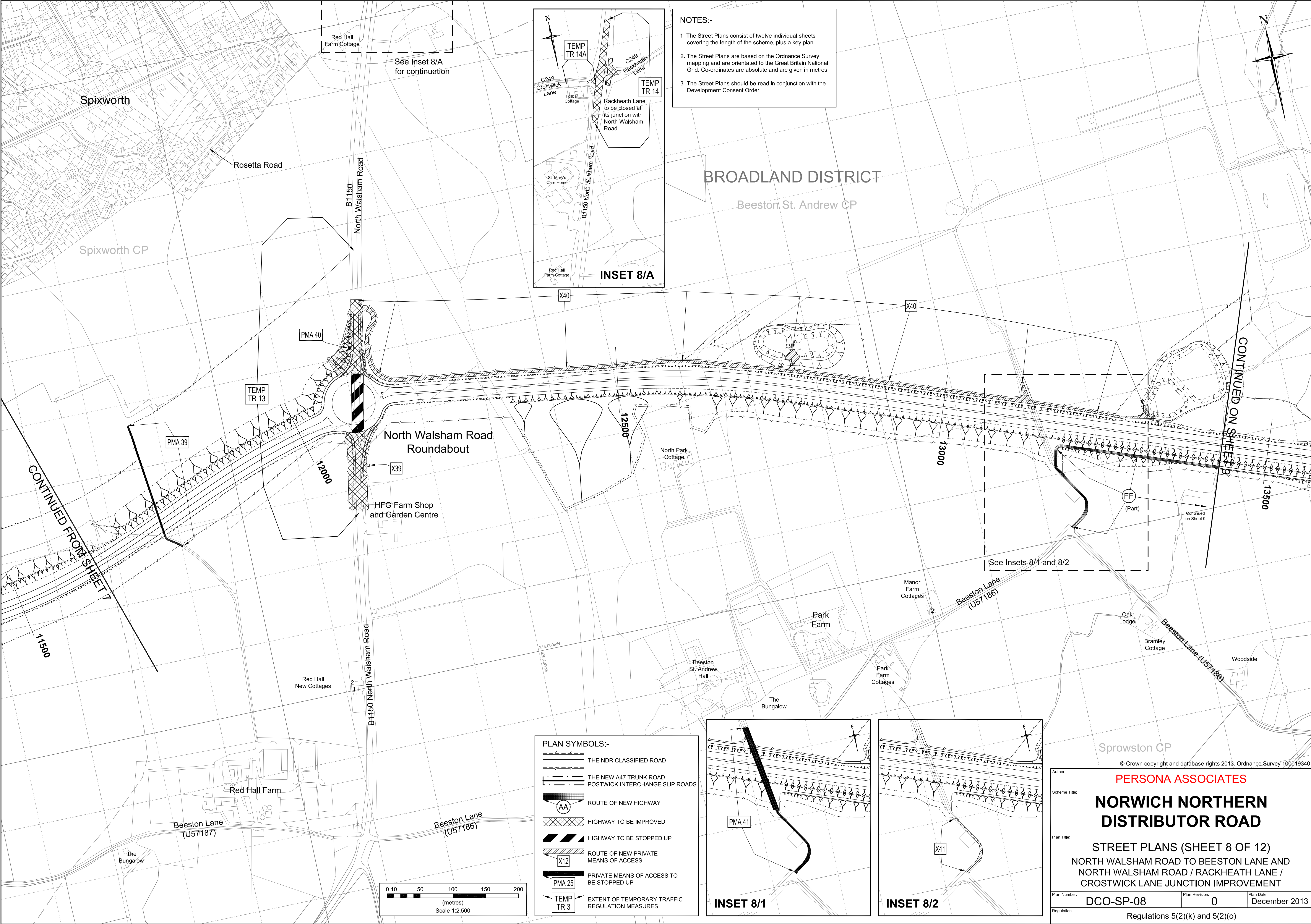

- NOTES:-**
1. The Street Plans consist of twelve individual sheets covering the length of the scheme, plus a key plan.
 2. The Street Plans are based on the Ordnance Survey mapping and are orientated to the Great Britain National Grid. Co-ordinates are absolute and are given in metres.
 3. The Street Plans should be read in conjunction with the Development Consent Order.

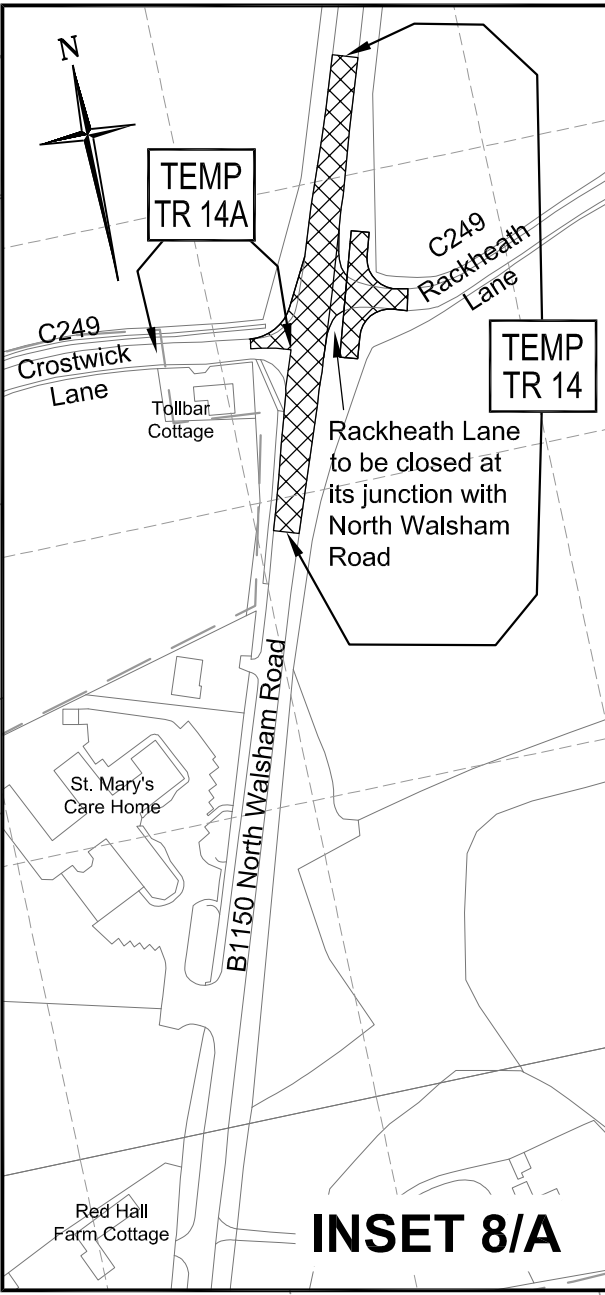

- PLAN SYMBOLS:-**
- THE NDR CLASSIFIED ROAD
 - THE NEW A47 TRUNK ROAD POSTWICK INTERCHANGE SLIP ROADS
 - ROUTE OF NEW HIGHWAY
 - HIGHWAY TO BE IMPROVED
 - HIGHWAY TO BE STOPPED UP
 - ROUTE OF NEW PRIVATE MEANS OF ACCESS
 - PRIVATE MEANS OF ACCESS TO BE STOPPED UP
 - EXTENT OF TEMPORARY TRAFFIC REGULATION MEASURES

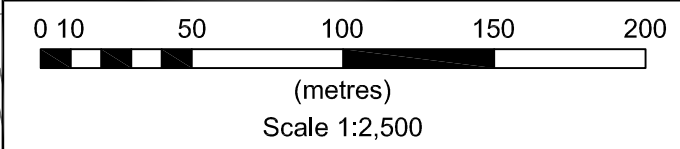

Author: PERSONA ASSOCIATES		
Scheme Title: NORWICH NORTHERN DISTRIBUTOR ROAD		
Plan Title: STREET PLANS (SHEET 8 OF 12) NORTH WALSHAM ROAD TO BEESTON LANE AND NORTH WALSHAM ROAD / RACKHEATH LANE / CROSTWICK LANE JUNCTION IMPROVEMENT		
Plan Number: DCO-SP-08	Plan Revision: 0	Plan Date: December 2013
Regulation: Regulations 5(2)(k) and 5(2)(o)		

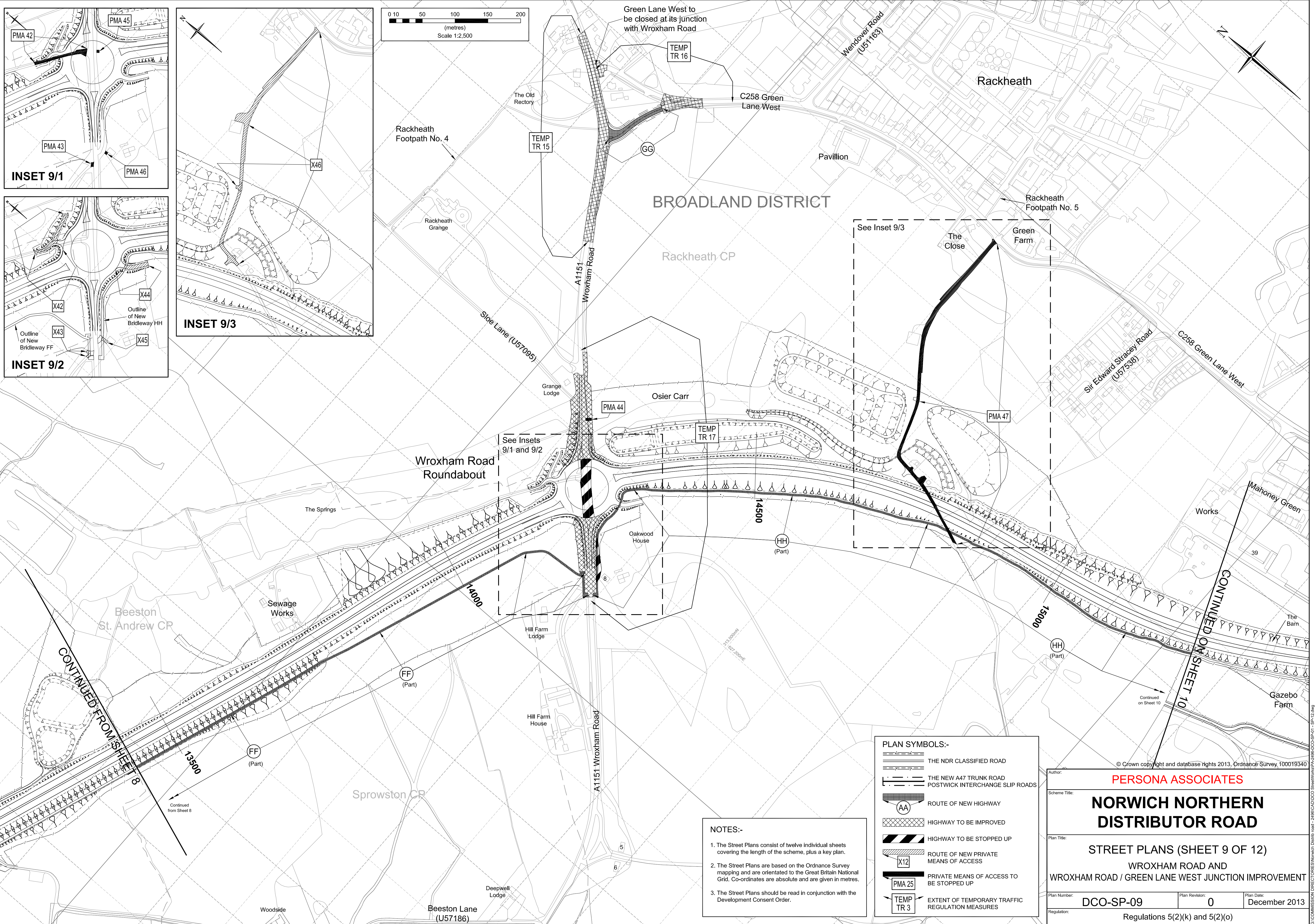
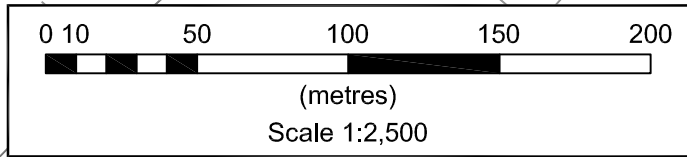
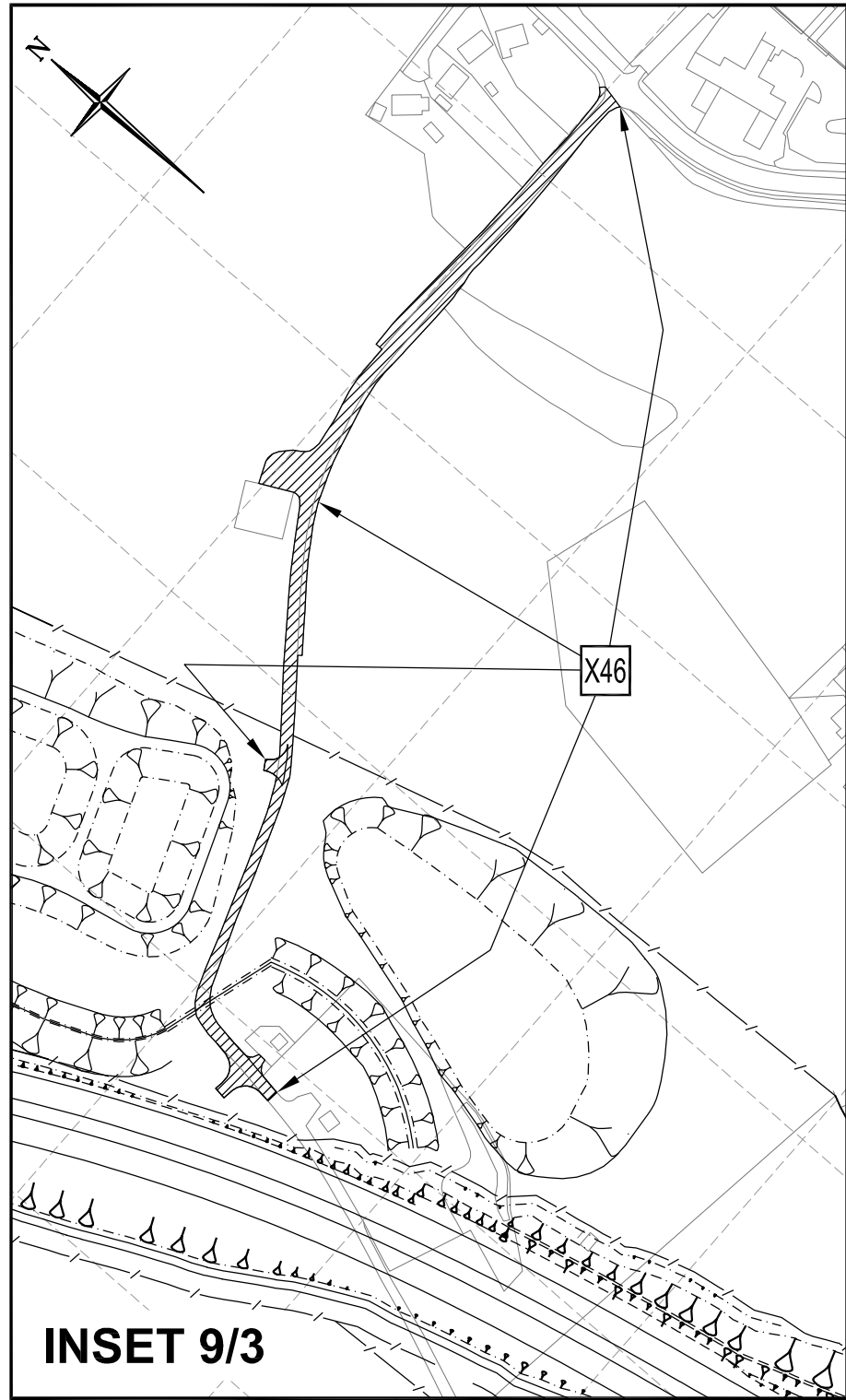
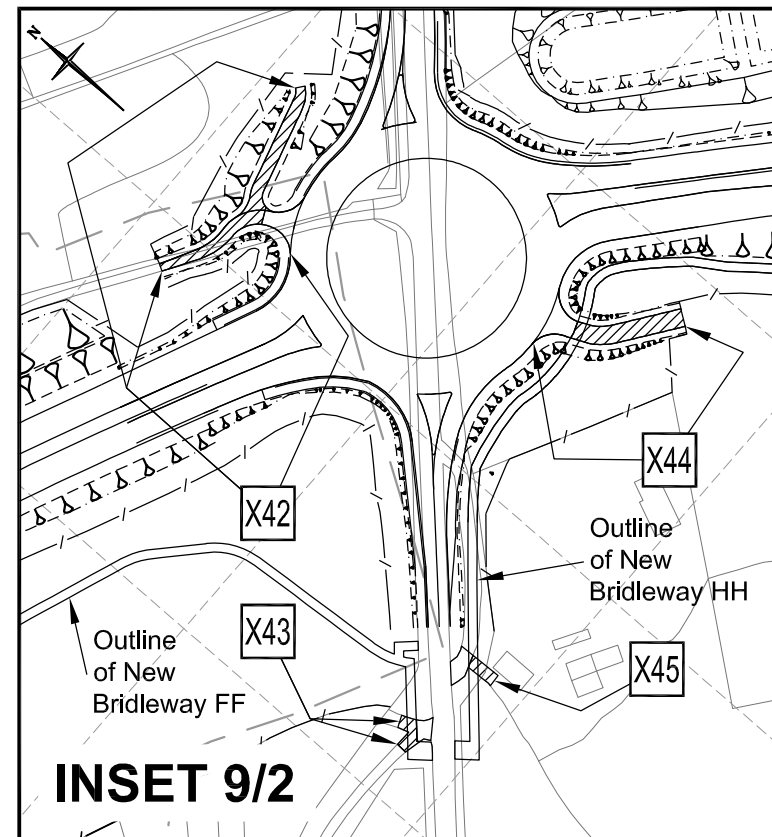
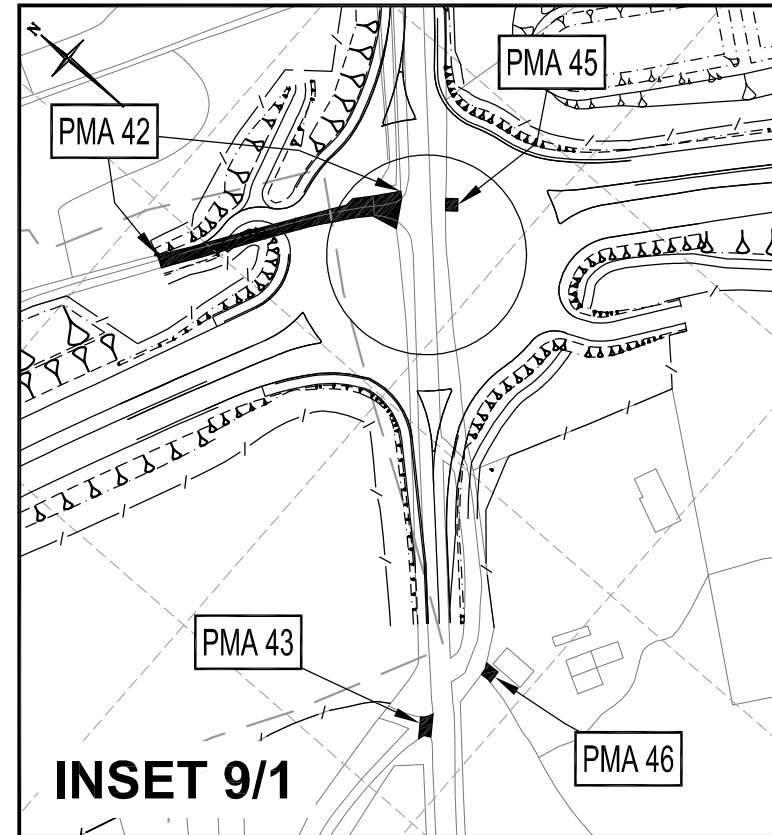

NOTES:-

1. The Street Plans consist of twelve individual sheets covering the length of the scheme, plus a key plan.
2. The Street Plans are based on the Ordnance Survey mapping and are orientated to the Great Britain National Grid. Co-ordinates are absolute and are given in metres.
3. The Street Plans should be read in conjunction with the Development Consent Order.

PLAN SYMBOLS:-

- THE NDR CLASSIFIED ROAD
- THE NEW A47 TRUNK ROAD POSTWORK INTERCHANGE SLIP ROADS
- ROUTE OF NEW HIGHWAY
- HIGHWAY TO BE IMPROVED
- HIGHWAY TO BE STOPPED UP
- ROUTE OF NEW PRIVATE MEANS OF ACCESS
- PRIVATE MEANS OF ACCESS TO BE STOPPED UP
- EXTENT OF TEMPORARY TRAFFIC REGULATION MEASURES

© Crown copyright and database rights 2013, Ordnance Survey 100019340

Author: PERSONA ASSOCIATES

Scheme Title:

NORWICH NORTHERN DISTRIBUTOR ROAD

Plan Title:

STREET PLANS (SHEET 9 OF 12)

WROXHAM ROAD AND WROXHAM ROAD / GREEN LANE WEST JUNCTION IMPROVEMENT

Plan Number:

DCO-SP-09

Plan Revision:

0

Plan Date:

December 2013

Regulation:

Regulations 5(2)(k) and 5(2)(o)

PLAN SYMBOLS:-

- THE NDR CLASSIFIED ROAD
- THE NEW A47 TRUNK ROAD POSTWICK INTERCHANGE SLIP ROADS
- ROUTE OF NEW HIGHWAY
- HIGHWAY TO BE IMPROVED
- HIGHWAY TO BE STOPPED UP
- ROUTE OF NEW PRIVATE MEANS OF ACCESS
- PRIVATE MEANS OF ACCESS TO BE STOPPED UP
- EXTENT OF TEMPORARY TRAFFIC REGULATION MEASURES

NOTES:-

- The Street Plans consist of twelve individual sheets covering the length of the scheme, plus a key plan.
- The Street Plans are based on the Ordnance Survey mapping and are orientated to the Great Britain National Grid. Co-ordinates are absolute and are given in metres.
- The Street Plans should be read in conjunction with the Development Consent Order.

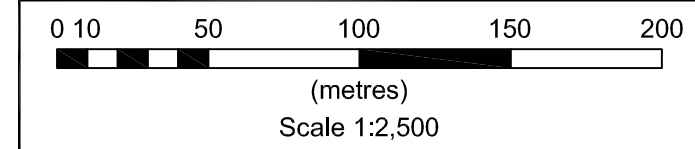
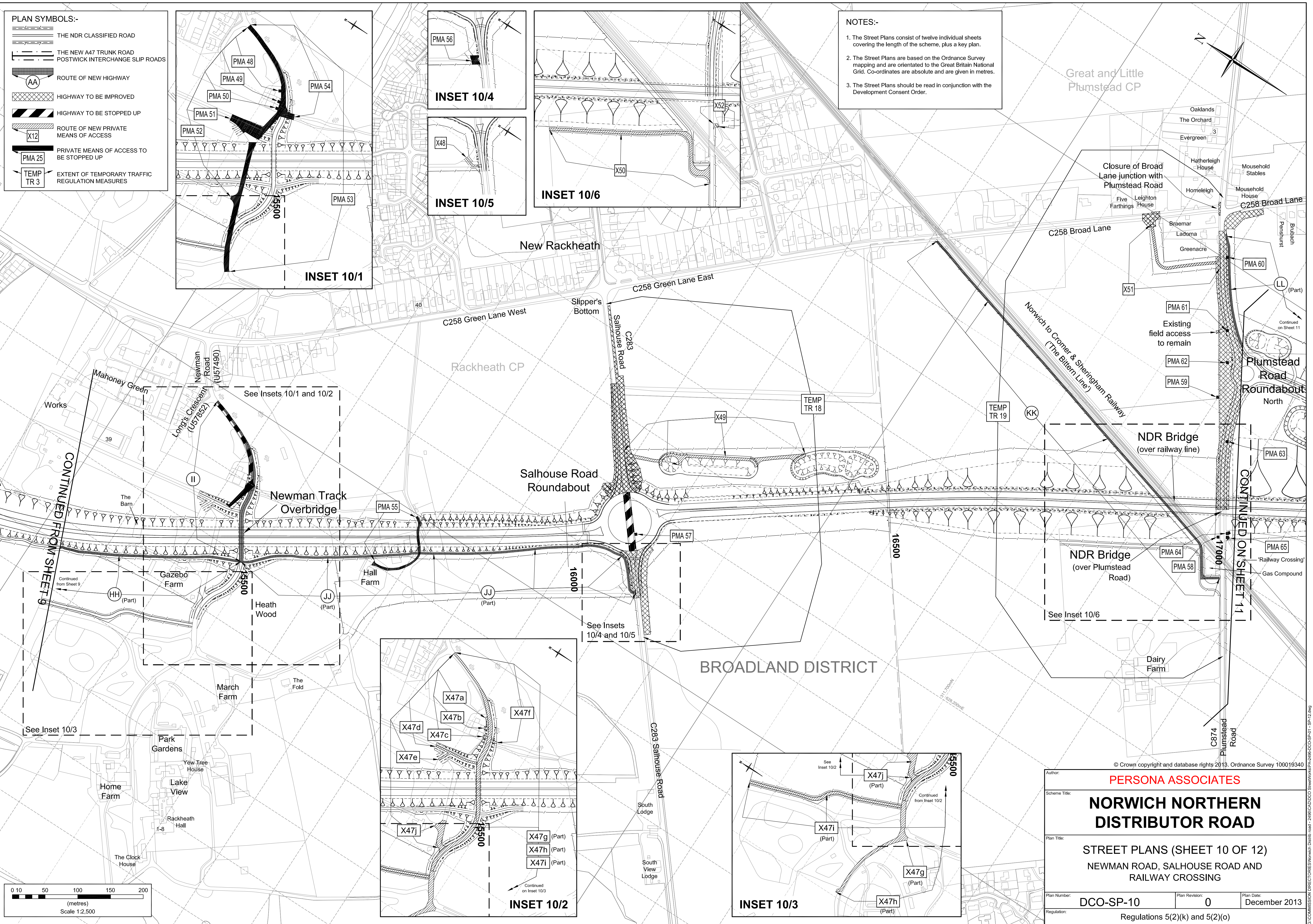

Author: **PERSONA ASSOCIATES**

Scheme Title: **NORWICH NORTHERN DISTRIBUTOR ROAD**

Plan Title: **STREET PLANS (SHEET 10 OF 12)**
NEWMAN ROAD, SALHOUSE ROAD AND RAILWAY CROSSING

Plan Number: **DCO-SP-10** Plan Revision: **0** Plan Date: **December 2013**

Regulation: **Regulations 5(2)(k) and 5(2)(o)**

G:\COMMISSION DIRECTOR\ORIS\Norwich Distributor Road - 2486 CAD\DCO StreetWorks\2486DCO-SP-01 - SP-10.dwg

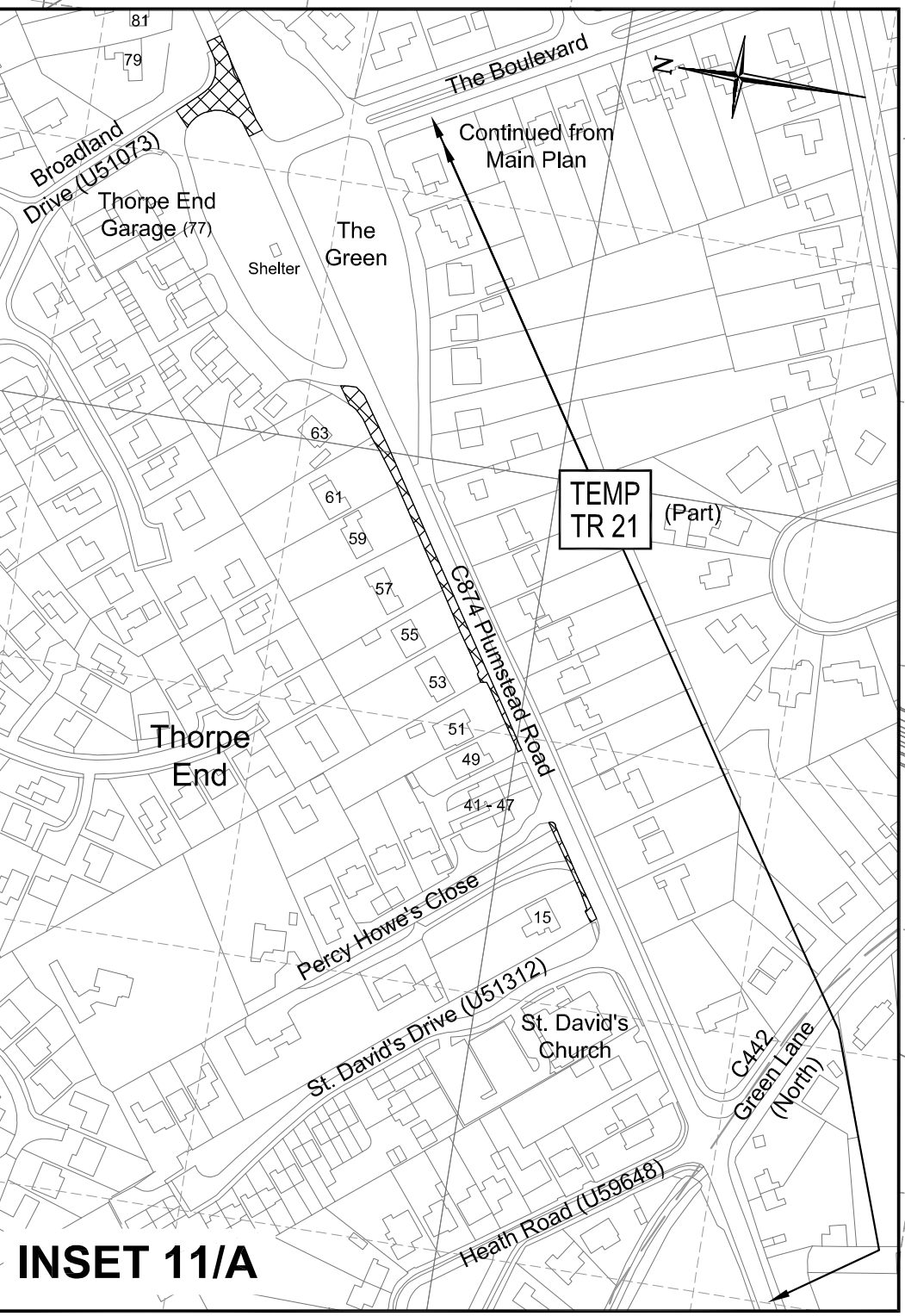
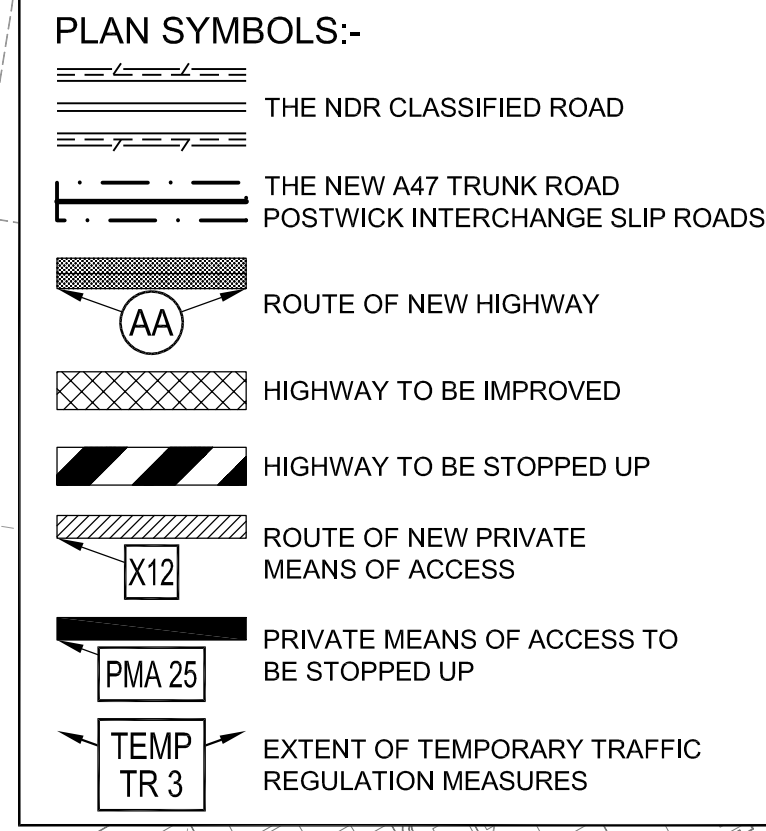
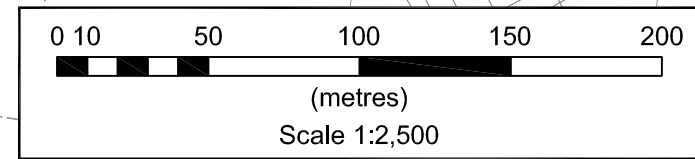
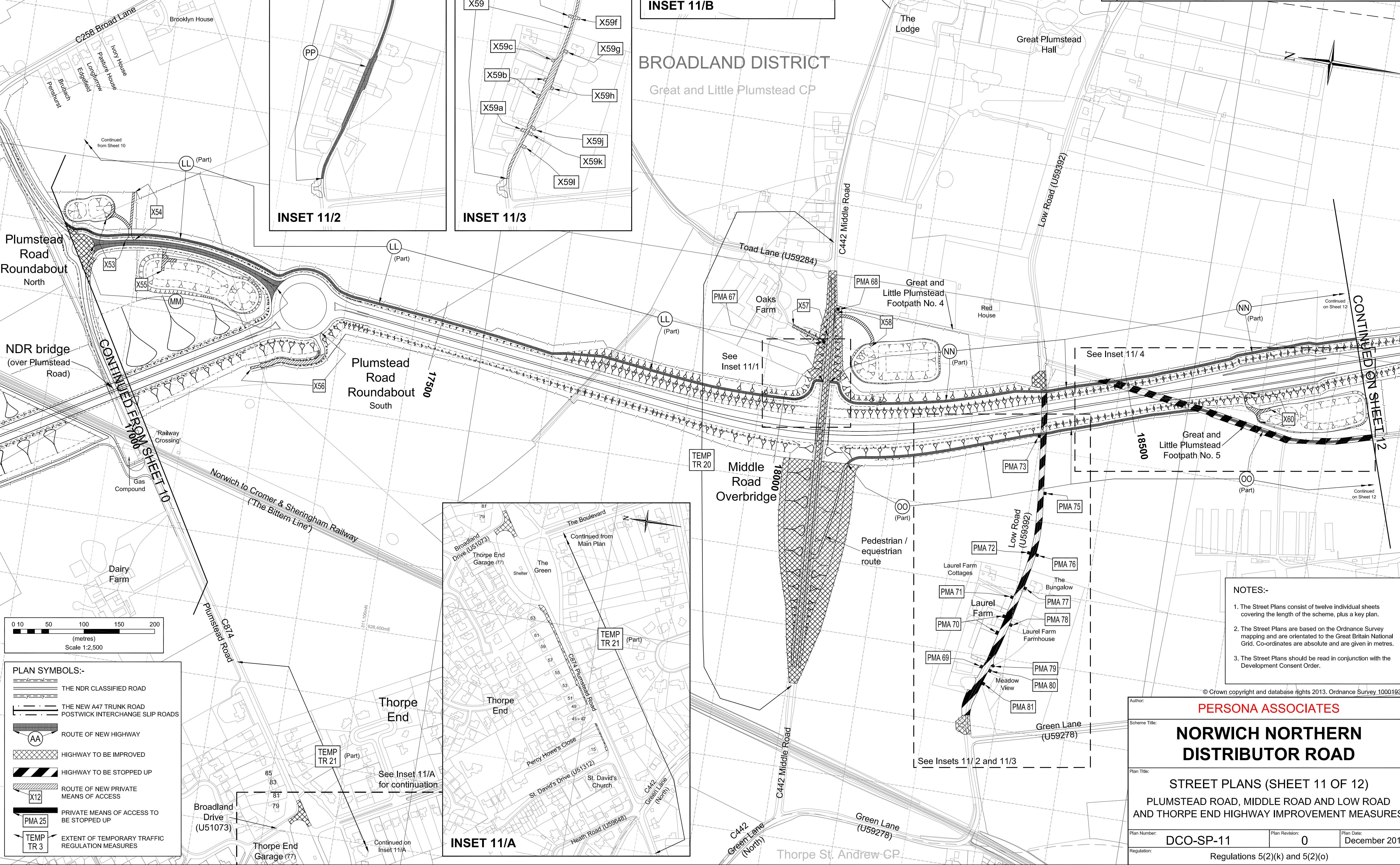
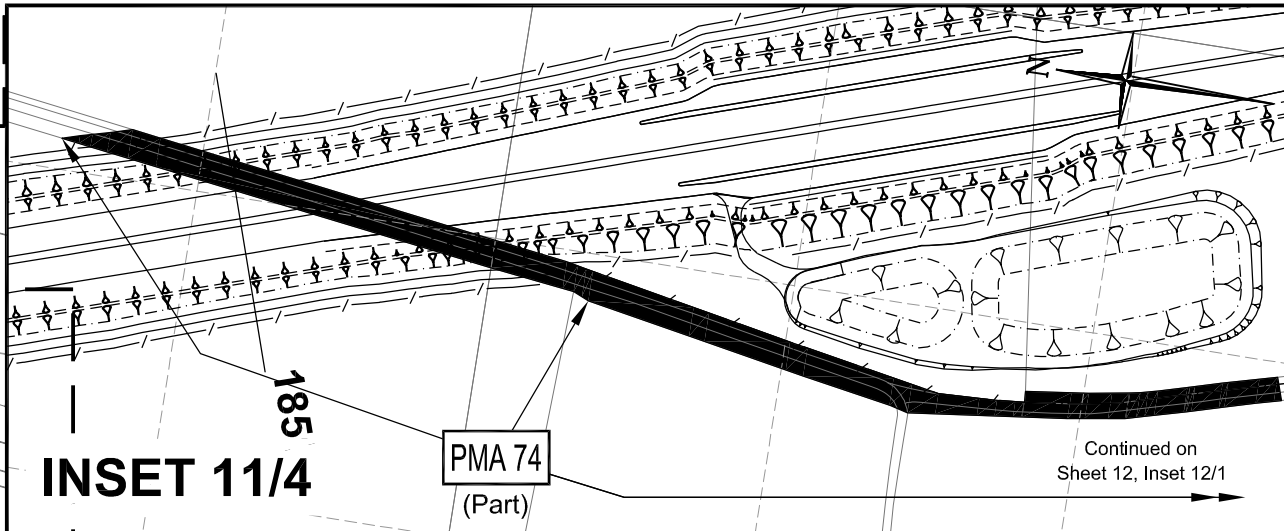
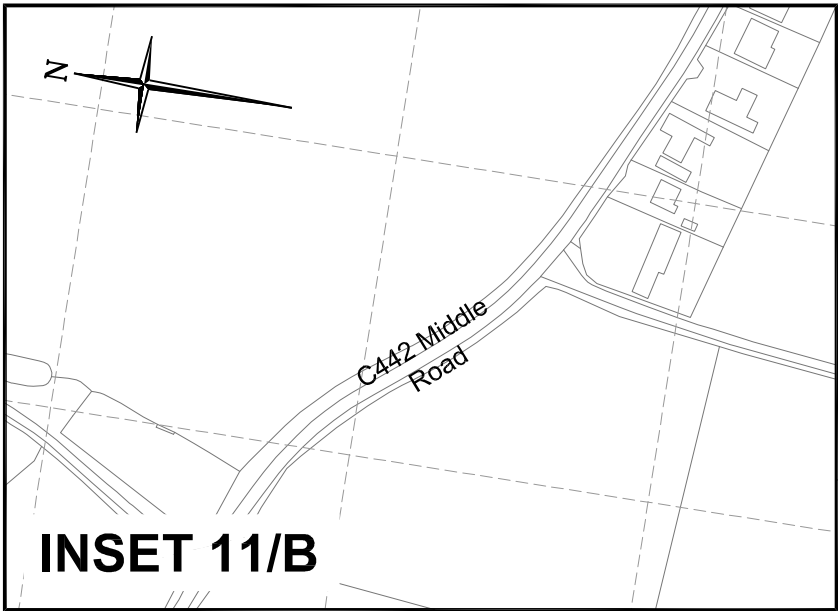
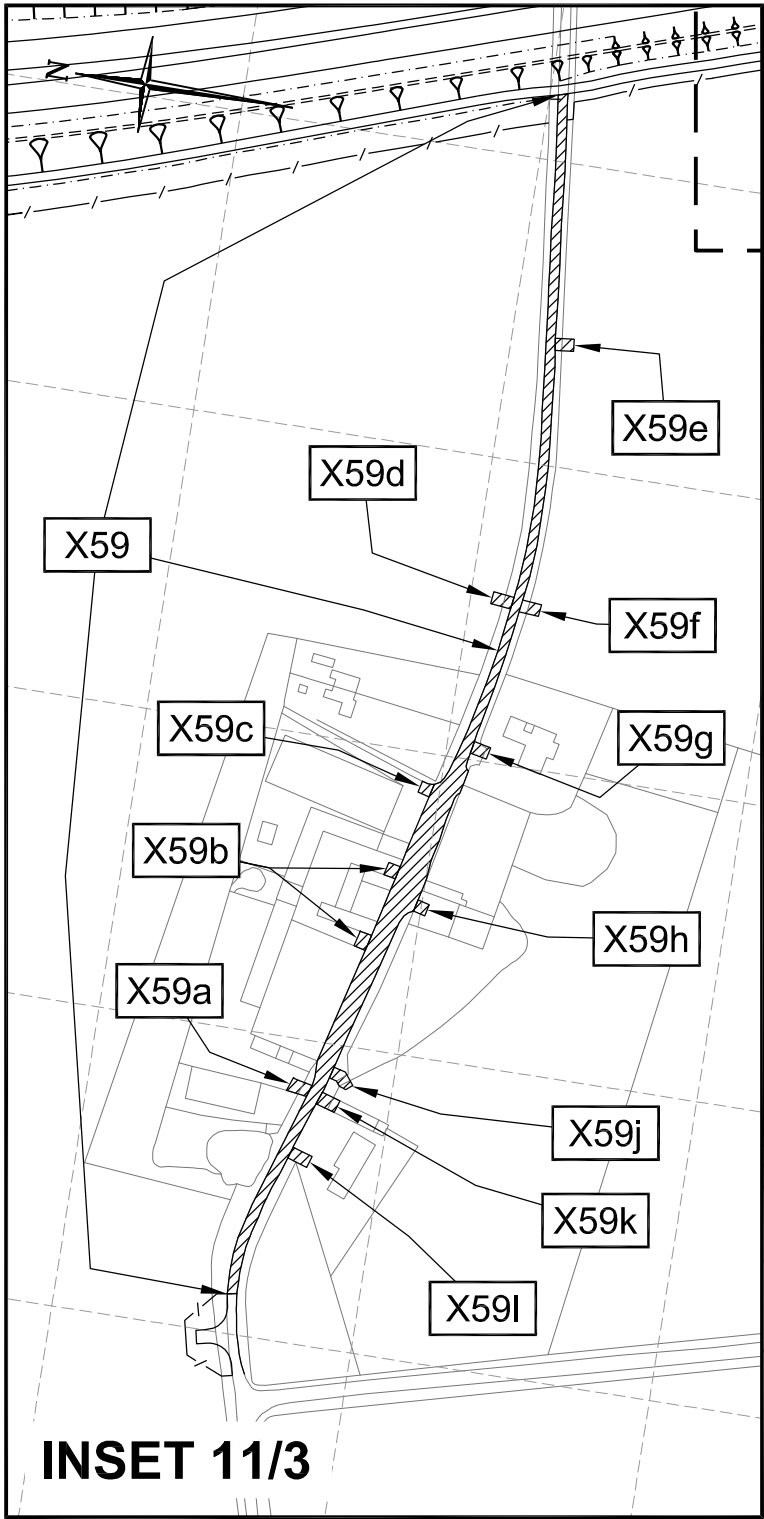
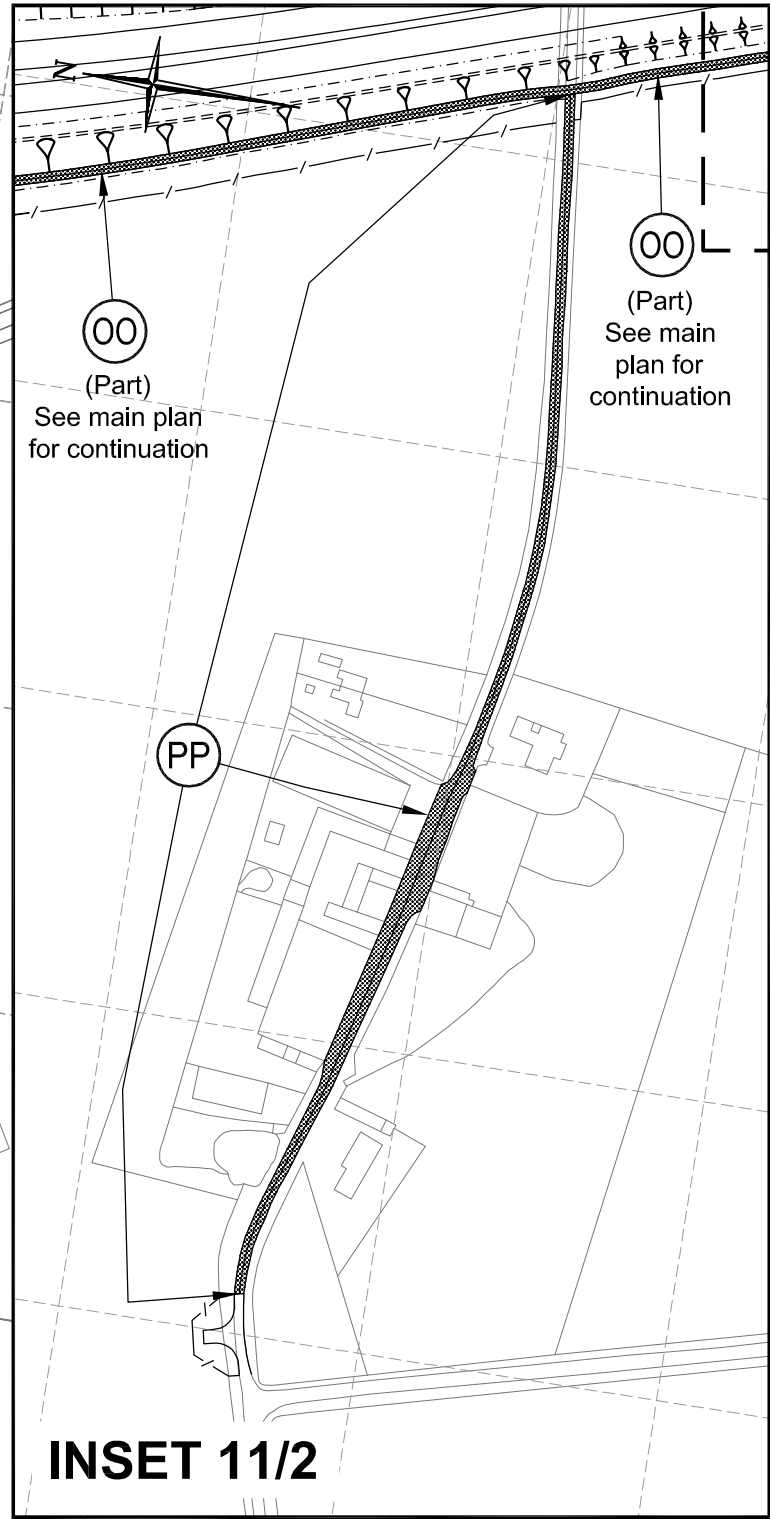
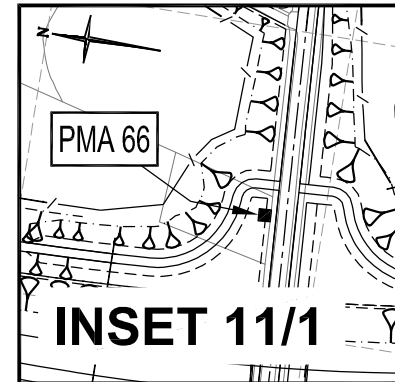

NOTES:-

1. The Street Plans consist of twelve individual sheets covering the length of the scheme, plus a key plan.
2. The Street Plans are based on the Ordnance Survey mapping and are orientated to the Great Britain National Grid. Co-ordinates are absolute and are given in metres.
3. The Street Plans should be read in conjunction with the Development Consent Order.

Author: PERSONA ASSOCIATES

Scheme Title: **NORWICH NORTHERN DISTRIBUTOR ROAD**

Plan Title: **STREET PLANS (SHEET 11 OF 12)**
PLUMSTEAD ROAD, MIDDLE ROAD AND LOW ROAD AND THORPE END HIGHWAY IMPROVEMENT MEASURES

Plan Number: DCO-SP-11 Plan Revision: 0 Plan Date: December 2013

Regulation: Regulations 5(2)(k) and 5(2)(o)

