

---

# The Norfolk County Council (Norwich Northern Distributor Road (A1067 to A47(T))) Order

---

## Minor Corrections to the Draft DCO Submitted on 20 November 2014, and Updated Version of One Sheet of the Outline Drainage Works Plan

---

Planning Act 2008

*PINS Reference Number: TR010015*

*Document Reference: NCC/EX/101*

*Author: Norfolk County Council*

Version	Date	Status of Version
0	27 November 2014	Final

This page has been left intentionally blank

## 1. INTRODUCTION

- 1.1 The Applicant submitted a revised Draft DCO for Deadline 10 (20 November 2014) and since then has noted some errors in the document. These are set out in the table below, and will be included in an updated version of the Draft DCO submitted prior to the end of the examination.
- 1.2 Insertions are shown in red underlined text and deletions in red strikethrough text.
- 1.3 The Applicant stated in paragraph 9.7.1 'Response to comments made by Interested Parties' (Document Ref NCC/EX/91) that plan R1C093-R1-5080 will be updated. This change is reflected in the table below and the updated plan (R1C093-R1-5080 Rev B) is included in Appendix A.

## 2. TABLE OF CORRECTIONS TO DRAFT DCO

Provision in Draft DCO	Correction Required
Schedule 2	Requirements
Table in 4(1)	<p>The right hand column for the row listing Outline drainage works will be amended as follows:</p> <p>"R1C093-R1-5064 Rev A, R1C093-R1-5065 Rev A, R1C093-R1-5066 Rev A, R1C093-R1-5067 Rev A, R1C093-R1-5068 Rev A, R1C093-R1-5069 Rev A, R1C093-R1-5070 Rev A, R1C093-R1-5071 Rev A, R1C093-R1-5072 Rev A, R1C093-R1-5073 Rev A, R1C093-R1-5074 Rev A, R1C093-R1-5075 Rev A, R1C093-R1-5076 Rev A, R1C093-R1-5077 Rev A, R1C093-R1-5078 Rev A, R1C093-R1-5079 Rev A, R1C093-R1-5080 Rev <del>AB</del>, R1C093-R1-5081 Rev A, R1C093-R1-5082 Rev A, R1C093-R1-5083 Rev A, R1C093-R1-5084 Rev A, R1C093-R1-5085 Rev A, R1C093-R1-5086 Rev A, R1C093-R1-5087 Rev A"</p>
6(1)	<p>"All hedges and trees forming part of the boundary of the Order land or situated within it (unless shown to be removed in the environmental statement or in a landscape and ecological management plan approved under requirement 5) must be protected from any damage during the construction of the authorised development in accordance with BS5837 (2012) 'Trees in relation to design, demolition and construction'."</p>
17(1)	<p>"No part of any numbered work in Schedule 1 (authorised development) is to commence until a written scheme covering the construction of that numbered work for the management and mitigation or emissions from the authorised development of-</p> <p>(i) odour;</p> <p>(ii) artificial light; and</p> <p>(iii) smoke</p> <p>has been submitted to and, following consultation with the relevant district authorities, approved by the relevant <u>planning</u> authority."</p>
22(1)	<p>"No public right of way to be closed or diverted during the construction of or as part of the operation of the authorised development is to be closed or diverted before the relevant <del>local</del> planning authority has given its approval to the details of the relevant closure or diversion."</p>

Provision in Draft DCO	Correction Required
26 (heading)	"Routeing to Norwich International Airport and Cromer"
Schedule 13 Part 1	Protective provisions – Network Rail
Paragraph 4(6)	"Prior to commencement of construction of the authorised development the undertaker must have obtained the approval of Network Rail to the design, specification, programme of works and method statement for the implementation of any works in respect of the bridge crossing the C874 Plumstead Road, Norwich (approximately 80 metres east of the railway crossing referred to in paragraph 4(5) provided that Network Rail may only approve those aspects of the design and specification that could affect the free, uninterrupted and safe use of any railway of Network Rail or the traffic thereon and the use by passengers of railway property and the undertaker will thereafter comply with the provisions of the approved design, specification, programme of works and method statement."
Paragraph 6(1)	Sub-paragraph numbering to be corrected so as to read "(a)" to "(d)"
Paragraph 9(4)	"If the cost of maintaining, working or renewing railway property is reduced in consequence of any such alterations or additions a capitalised sum representing such saving is to be set off against any sum payable by the undertaker to Network Rail under this paragraph.#"

This page has been left intentionally blank

# Appendix A

---

This page has been left intentionally blank



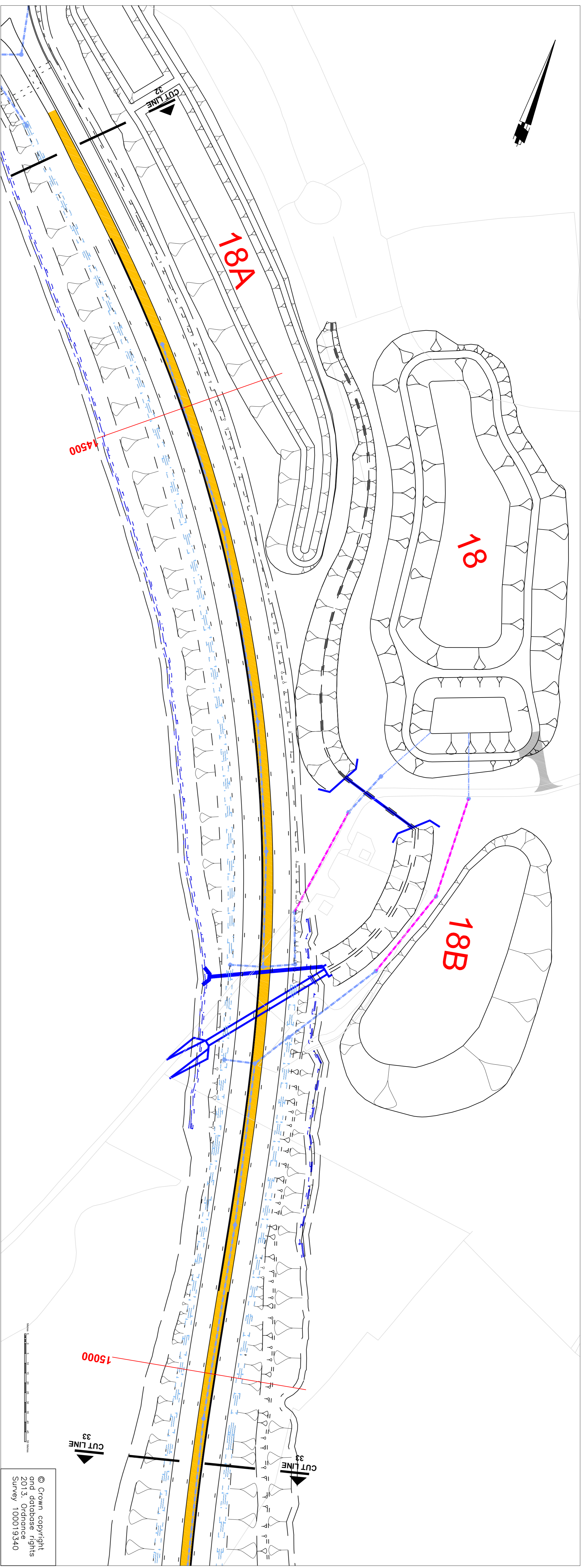



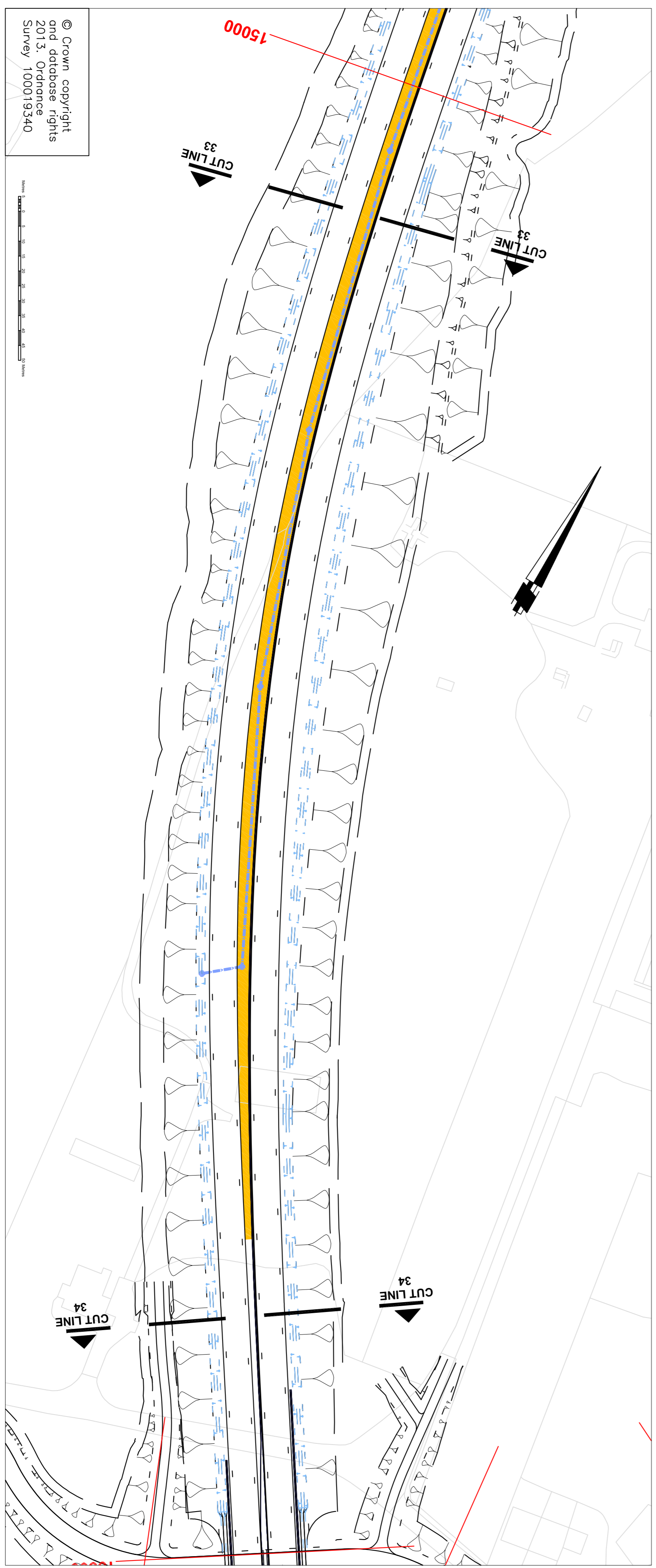



© Crown copyright  
and database rights  
2013. Ordnance  
Survey 100019340

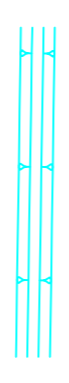

© Crown copyright  
and database rights  
2013. Ordnance  
Survey 100019340

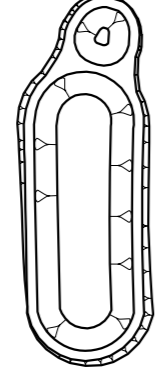
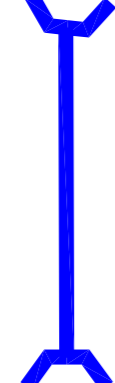
**KEY**

-  Proposed Ditch
-  Proposed Swale
-  Proposed Bitumen Channel
-  Proposed Pipe Network
-  Proposed Manhole
-  Proposed Lagoon
-  Proposed Culvert
-  Chainage

Plan to be read in conjunction with the  
Development Consent Order.  
Regulations 5(2)(p) and 6(2)(a)

REV.	DESCRIPTION	CHECKED	DATE
0	Revision for Submission	JB	11/13
A	Lagoon 18 re-striping	MKu	10/14
B	New Filter Drains at Lagoon 18B	MKu	11/14

INITIALS	DATE	DRAWING No.
SURVEYED BY OS	2013	RTIC093-R1-5080B
DESIGNED BY JT/BF	07/13	PROJECT TITLE Norwich Northern Distributor Road
DRAWN BY JT	11/13	SCALE 1:1000
CHECKED BY JB	11/13	FILE No. RTIC093