

Norfolk County Council
County Hall, Martineau Lane
Norwich
NR1 2SG

December 20, 2018

I, Dr David Ormerod of Mill House, 7 Mill Lane, Swaffham, Norfolk PE37 7EU hereby apply for an order under section 53(2) of the Wildlife and Countryside Act 1981 to modify the definitive map and statement for the area by:

Upgrading Wereham FP1, part of Gibbet Lane, and Wereham FP2 to a Restricted Byway or Bridleway. Starting in what is now the Fincham Village Nature Reserve at TF 68300398, Skinners Lane passes south in Wereham Parish and merges with the southern part of the old Priory Road to join Gibbet Lane, at TF 67980285. This section is currently Wereham FP1. Six hundred yards to the east along the quiet Gibbet Lane, the remaining section of Black Drove continues on south from TL 68560274 as Wereham FP2. A bypass for the Fincham Nature Reserve may have to be found to connect with Wereham FP1 from Black Drove. There is an appropriate area of unfarmed wasteland close by. This land is owned by a Farmer Dennis; c a contact address is provided.

I attach copies of the following documentary evidence including statements of witnesses in support of this application:

- Ordnance Survey 1:25,000 County Series, Norfolk Sheet TF60, 1956
- Norfolk County Council Internet Gazetteer, 2018
- Finance Act (1909-10) IRS Duties on Land Values Map, Wereham/ Stoke Ferry
- Fincham Enclosure Award 1772/1804
- Faden's Map of Norfolk, 1797
- Stoke Ferry Enclosure map and Award, including Dereham and Winnold Hamlet, 1818
- Ordnance Survey First Series 1:1,000,000 Wereham, 1824
- Bryant's Map of Norfolk, 1826
- Wereham Parish Tithe Map and Award 1840
- Ordnance Survey Boundary Sketch Map, Wereham and West Dereham, 1882
- Ordnance Survey 6-inch , Norfolk Sheet 69NE, Wereham, 1884
- Ordnance Survey Object Name Book, Wereham, 1904
- Ordnance Survey 2nd Series 25-inch County Series, Norfolk Sheets 59.1 and 59.5, 1905
- Finance Act (1909-10) IRS Duties on Land Valuation Map, Wereham

- Bartholomew Cycling/Tourism maps: 1921; 1943
- Ministry of Food National Farm Survey Map, Norfolk Sheet 59, 1943
- Ordnance Survey one-inch New Popular Edition, Sheet 124, Kings Lynn, Wereham, 1946
- Ordnance Survey 1:25,000 Norfolk Sheet TF60, Wereham, 1955
- Aerial View of north Wereham, 1988
- INSPIRE land index polygon map, 2018
- Applicant's statement.

Sincerely Yours,

A handwritten signature in dark ink, appearing to read 'L David Ormerod', written in a cursive style.

L David Ormerod MB,BS, MBA, MSc, FRCP, FRCS, DTM&H

Applicant's Reference: EH010

Wildlife and Countryside Act 1981

The Definitive Map and Statement of Public Rights of Way for the County of Norfolk

Certificate of Service of Notice of Application for Modification Order for Wereham FP1 and FP2

To: Norfolk County Council
County Hall
Martineau Lane
Norwich NR1 2SG

I, Dr David Ormerod of Mill House, 7 Mill Lane, Swaffham PE37 7EU hereby certify that the requirements of paragraph 2 of Schedule 14 to the Wildlife and Countryside Act 1981 have been complied with.

Dated: 20 December 2018

Signature:



Applicant's Reference: EH010
NCC Reference:

Schedule of persons on whom notice was served

1. Besenel Farm, Black Drove, Fincham, Norfolk, PE33 9HQ
2. Albanwise Farming Ltd, Estate Office, Green Farm, Saxlingham, Holt, Norfolk NR25 7JX
3. Woodstock Farm Ltd, Gibbet Lane, West Dereham, Norfolk PE33 9BE
4. Peter Wales Contracting, Marham Hall, Marham Norfolk PE39 9HT
5. Sarah Thorpe, Fincham Parish Council, 88 Smeeth Road, Marshland St. James, Wisbech, Cambs PE14 8JF
6. Letter posted in transparent cover to post (ii) near exit of Wereham FP1 at Gibbet Road; (ii) Wereham FP2 on Gibbet Road; and (iii) at entry to Fincham Nature Reserve
7. Farmer Dennis. Agent: Cruso & Wilkin, Waterloo Street, Kings Lynn PE30 1NZ

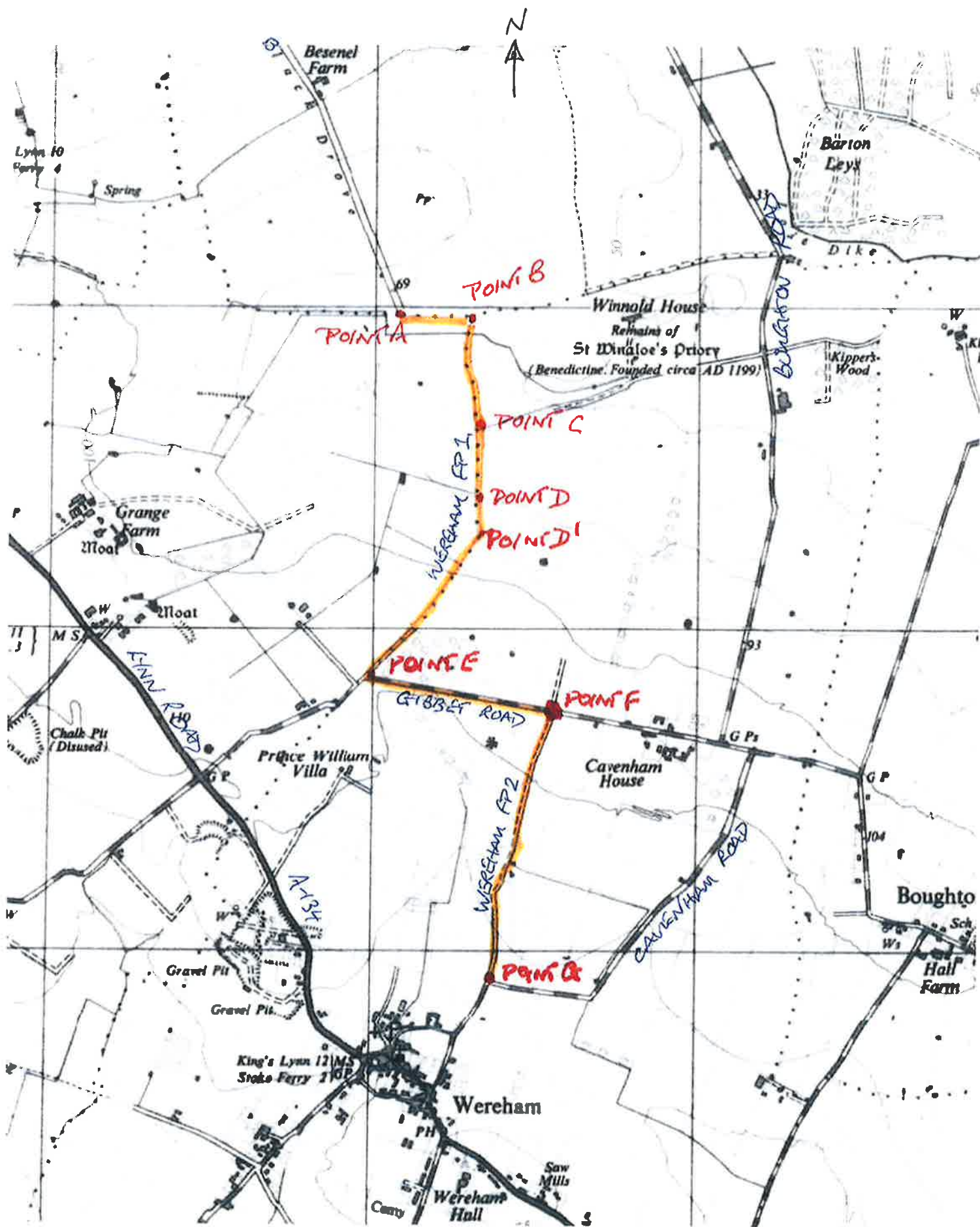

FIGURE 1. THE APPLICATION ROUTE. OS 1:25,000 NORFOLK MAP TF60, 1955.

SEE TEXT FOR DETAILS. IT COMPRISES WERHAM FP1, A SECTION OF GIBBET ROAD, AND WERHAM FP2. THERE ARE NO PERMANENT MAP CHANGES MORE RECENTLY.