

Form of application for Modification Order

Wildlife and Countryside Act 1981

Definitive Map and Statement of Public Rights of Way for the County of Norfolk

To: Norfolk County Council

Of: County Hall, Martineau Lane, Norwich, Norfolk, NR1 2SG

I/~~we~~ **MICHAEL SEDGWICK**

of **6 RIVER WALK, GREAT YARMOUTH, NORFOLK, NR20 4BZ**

hereby apply for an Order under Section 53(2) of the Wildlife and Countryside Act 1981 modifying the Definitive Map and Statement for the area by (please delete as required):

~~deleting the footpath / bridleway / restricted byway / byway open to all traffic from to~~

X adding the footpath / bridleway / restricted byway / byway open to all traffic from **Tar Wom's Road** to **Done Park, West Caister PR10**

~~upgrading/downgrading to a footpath / bridleway / restricted byway / byway open to all traffic/~~

~~the footpath / bridleway / restricted byway / byway open to all traffic from to~~

Riverbank footpath

~~varying/adding to the particulars relating to the footpath / bridleway / restricted byway / byway open to all traffic~~

~~from to~~

~~by providing that~~

and shown on the map accompanying this application.

I/~~we~~ attach copies of the following documentary evidence (including statements of witnesses) in support of this application:

List of Documents

**User Evidence Form 2, Maps, photographs, o/s Map
HM Land Registry Title extract**

Dated: **26th September 2018**

Signed: 

**Form of certificate of service of notice of
application for Modification Order**

WILDLIFE AND COUNTRYSIDE ACT 1981

Definitive Map and Statement of Public Rights of Way for the County of Norfolk

Certificate of Service of Notice of Application for Modification Order

To: Norfolk County Council

of: County Hall, Martineau Lane, Norwich, Norfolk, NR1 2SG

~~I/We~~ **MICHAEL SEIGNICK**

of **6 RIVER WALK, GREAT YARMOUTH, NORFOLK, NR20 4BZ**

hereby certify that the requirements of paragraph 2 of Schedule 14 to the Wildlife and Countryside Act 1981 have been complied with.

Dated **26th September 2018**

Signed 

(on behalf of)

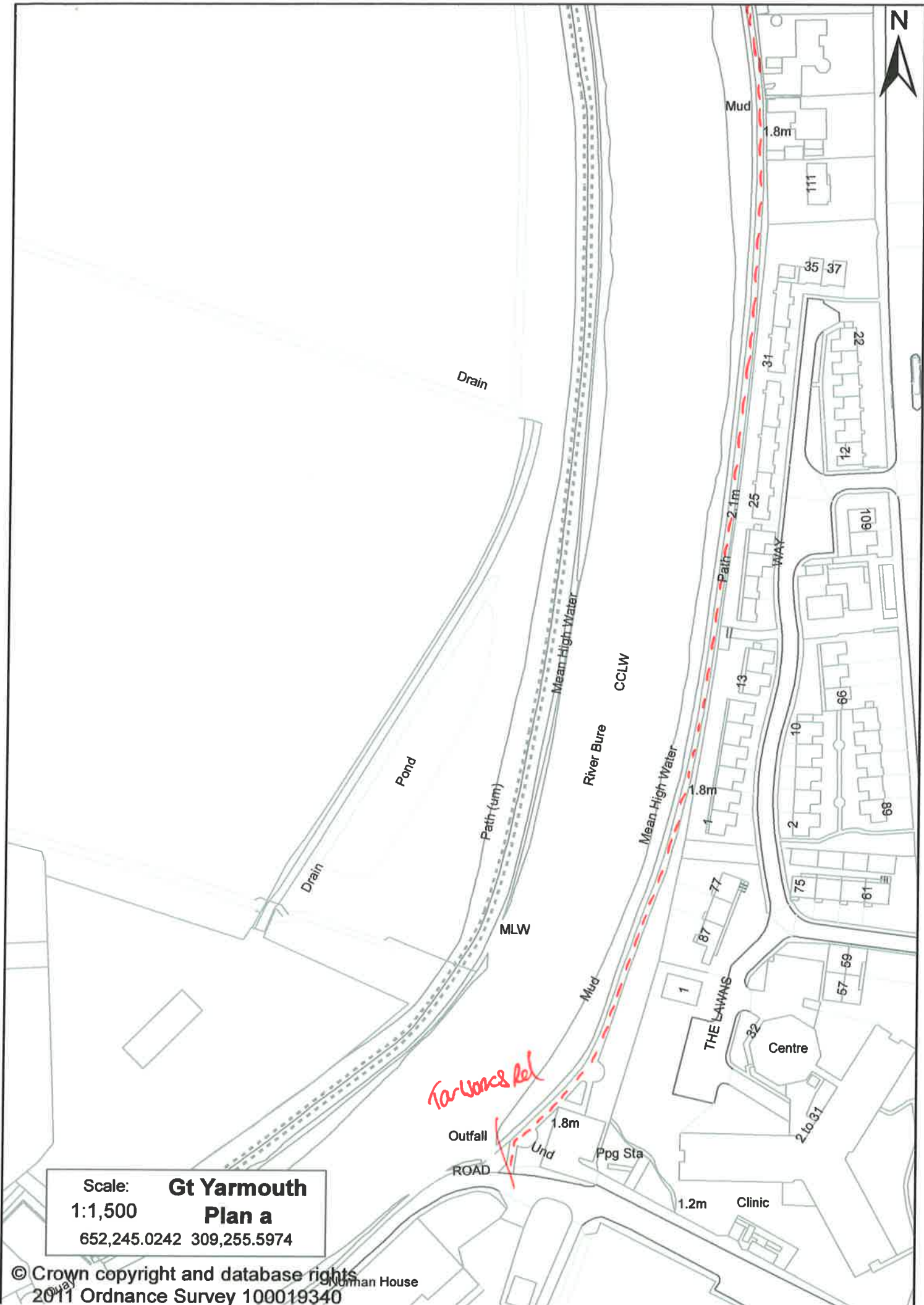

Scale: **Gt Yarmouth**
1:1,500 **Plan a**
652,245.0242 309,255.5974

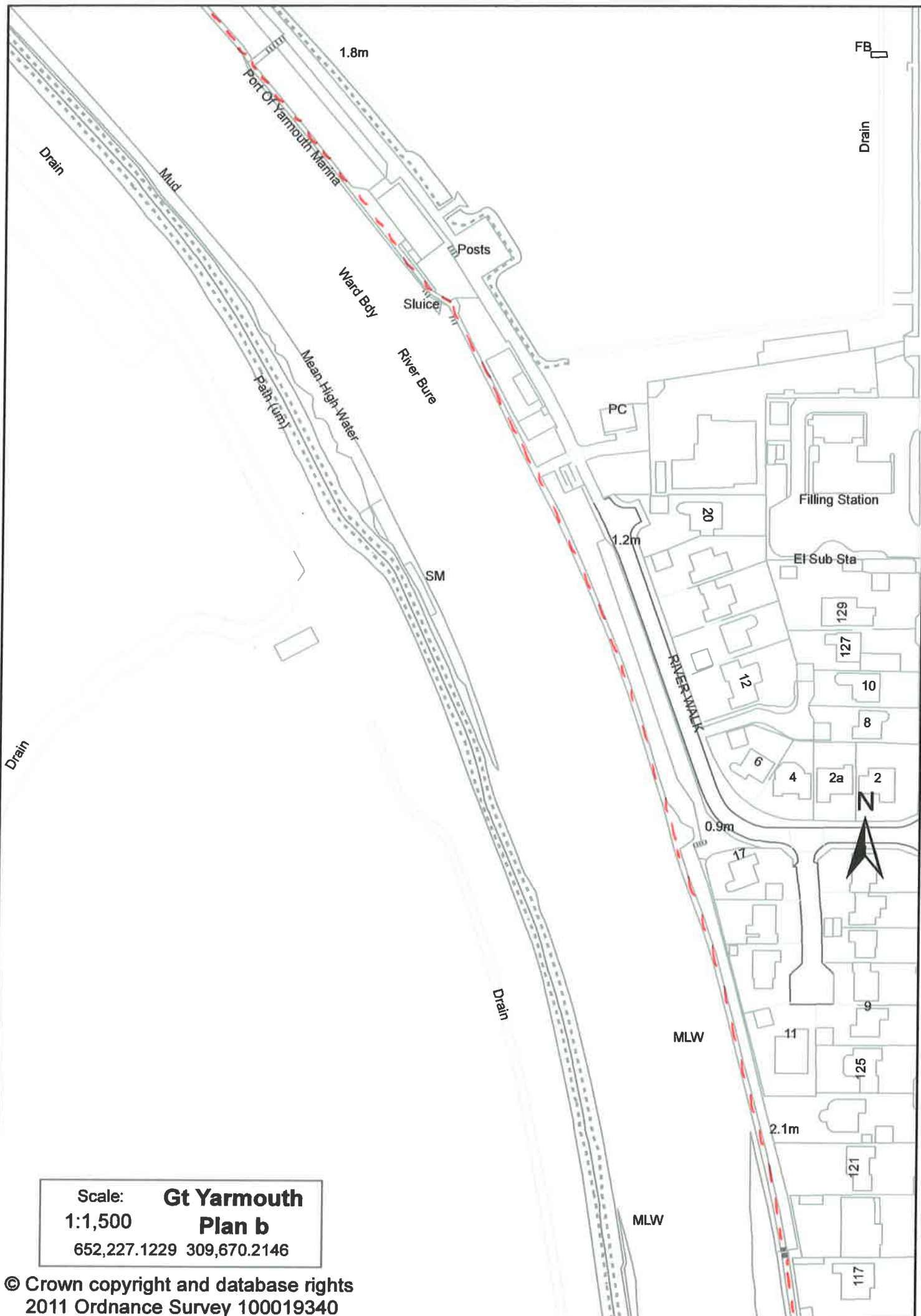

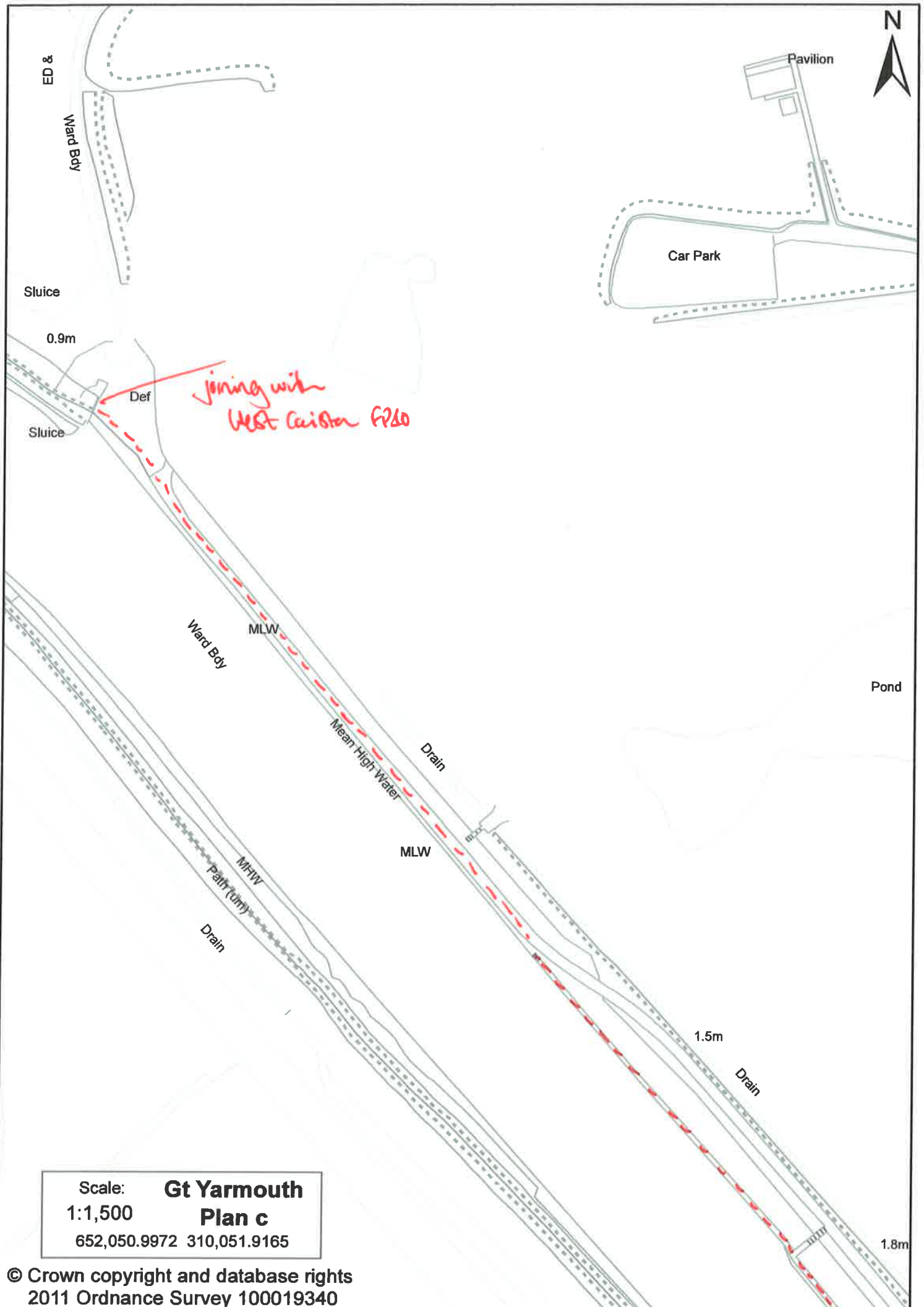

Scale:

1:1,500

Gt Yarmouth

Plan c

652,050.9972 310,051.9165